

SECTION **RS**

GI

MA

EM

LC

EC

FE

AT

FA

RA

BR

ST

RS

BT

HA

EL

IDX

CONTENTS

PRECAUTIONS AND PREPARATION	2	Removal.....	18
Supplemental Restraint System (SRS) "AIR BAG"	2	Installation.....	19
SEAT BELTS	3	Front Passenger Air Bag Module	20
Front Seat Belt.....	4	Removal.....	20
Rear Seat Belts.....	6	Installation.....	21
Built-In Child Seat.....	8	Disposal of Air Bag Module	22
Seat Belt Inspection.....	10	TROUBLE DIAGNOSES — Supplemental Restraint System (SRS)	26
SUPPLEMENTAL RESTRAINT SYSTEM (SRS)	13	How to Perform Trouble Diagnoses for Quick and Accurate Repair	26
Precautions for SRS "Air Bag" Service.....	13	Schematic	28
Special Service Tools.....	13	Wiring Diagram –SRS–	29
Description	14	Self-diagnosis.....	31
SRS Component Parts Location.....	14	Diagnostic Procedure	31
Maintenance Items.....	15	Trouble Diagnoses for Air Bag Warning Lamp.....	44
Diagnosis Sensor Unit	16	Diagnostic Procedure	44
Removal And Installation	16	COLLISION DIAGNOSIS	46
Driver Air Bag Module and Spiral Cable	18		

When you read wiring diagrams:

- Read GI section, "HOW TO READ WIRING DIAGRAMS".
- See EL section, "POWER SUPPLY ROUTING" for power distribution circuit.

When you perform trouble diagnoses, read GI section, "HOW TO FOLLOW FLOW CHART IN TROUBLE DIAGNOSES" and "HOW TO PERFORM EFFICIENT DIAGNOSIS FOR AN ELECTRICAL INCIDENT".

Supplemental Restraint System (SRS) “AIR BAG”

The Supplemental Restraint System “AIR BAG”, used along with a seat belt, helps to reduce the risk or severity of injury to the driver and front passenger in a frontal collision. The Supplemental Restraint System consists of air bag modules (located in the center of the steering wheel and in the instrument panel on the passenger side), a diagnosis sensor unit, warning lamp, wiring harness and spiral cable.

WARNING:

- **To avoid rendering the SRS inoperative, which could increase the risk of personal injury or death in the event of a collision which would result in air bag inflation, all maintenance should be performed by an authorized NISSAN dealer.**
- **Improper maintenance, including incorrect removal and installation of the SRS, can lead to personal injury caused by unintentional activation of the system.**
- **Do not use electrical test equipment on any circuit related to the SRS unless instructed to in this Service Manual. SRS wiring harnesses are covered with yellow insulation either just before the harness connectors or on the complete harness, for easy identification.**

SEAT BELTS

CAUTION:

- Do not disassemble buckle or seat belt assembly.
- Replace anchor bolts if they are deformed or worn out.
- Never oil tongue and buckle.
- If any component of seat belt assembly is questionable, do not repair. Replace the seat belt assembly.
- If webbing is cut, frayed, or damaged, replace seat belt assembly.
- When replacing seat belt assembly, use a genuine NISSAN seat belt assembly.
- After any collision, inspect all seat belt assemblies, including retractors and other attached hardware.

GI

MA

EM

LC

EC

FE

AT

FA

RA

BR

ST

RS

BT

HA

EL

IDX

SEAT BELTS

Front Seat Belt

SEC. 868

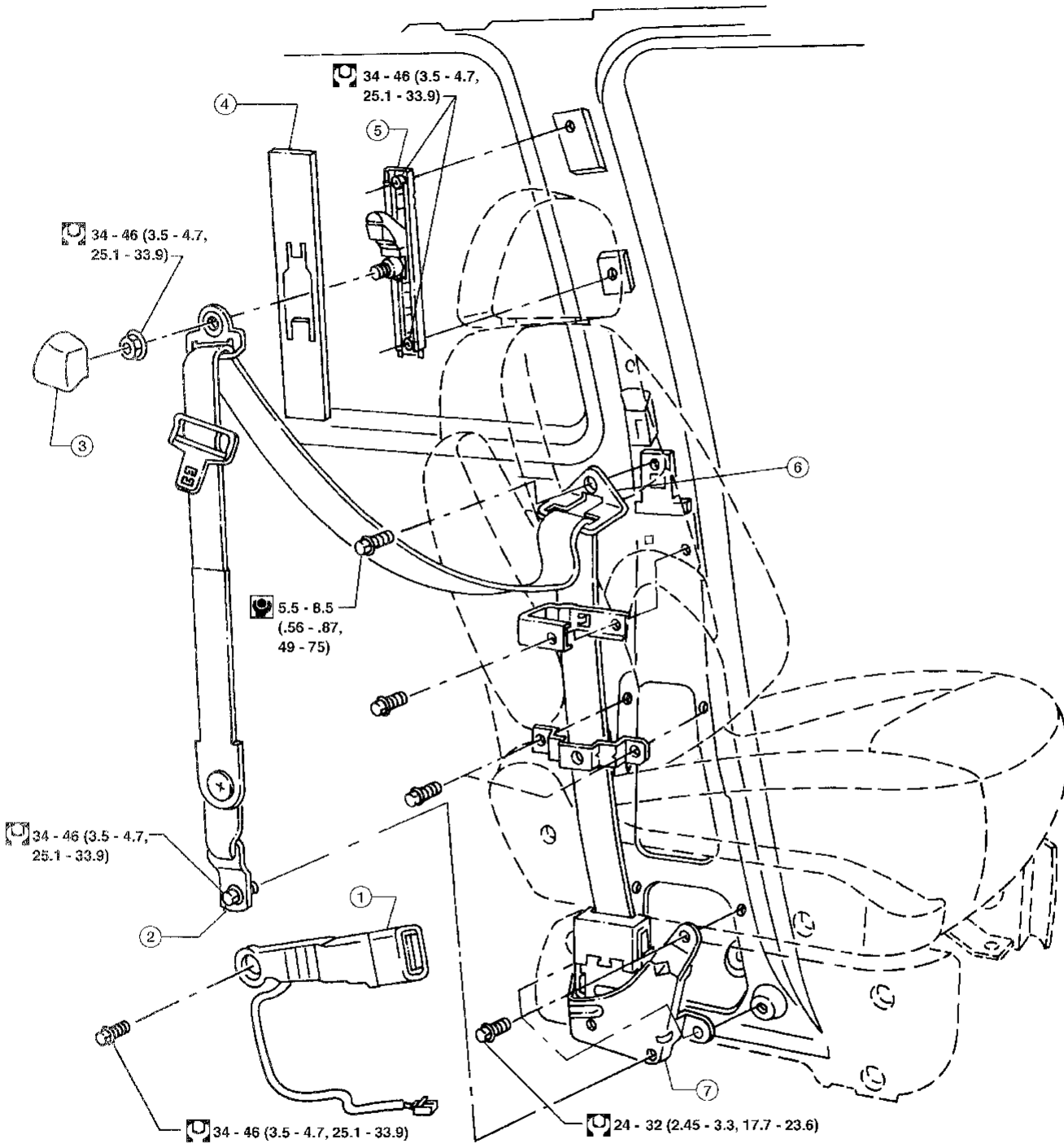

: N·m (kg-m, in-lb)

: N·m (kg-m, ft-lb)

ARS154

SEAT BELTS

Front Seat Belt (Cont'd)

REMOVAL

- ① Remove buckle from seat. For driver's side, disconnect harness connector.
- ② Remove lower seat belt anchor bolt.
Remove side trim from lower B-pillar. Refer to BT section ("Side and Floor Trim", "INTERIOR TRIM").
- ③ Remove D-ring cover and shoulder nut.
Remove B-pillar upper trim.
- ④ Remove adjuster slide plate cover.
- ⑤ Remove two adjuster bolts and adjuster assembly.
- ⑥ Remove mid-guide.
- ⑦ Remove three retractor bolts.
Remove retractor.

GI

MA

EM

LC

EC

FE

AT

FA

RA

BR

ST

RS

BT

HA

EL

IDX

SEAT BELTS

Rear Seat Belts

SEC. 869

Second row seat belt retractor
RH shown

(With second row bench seat)

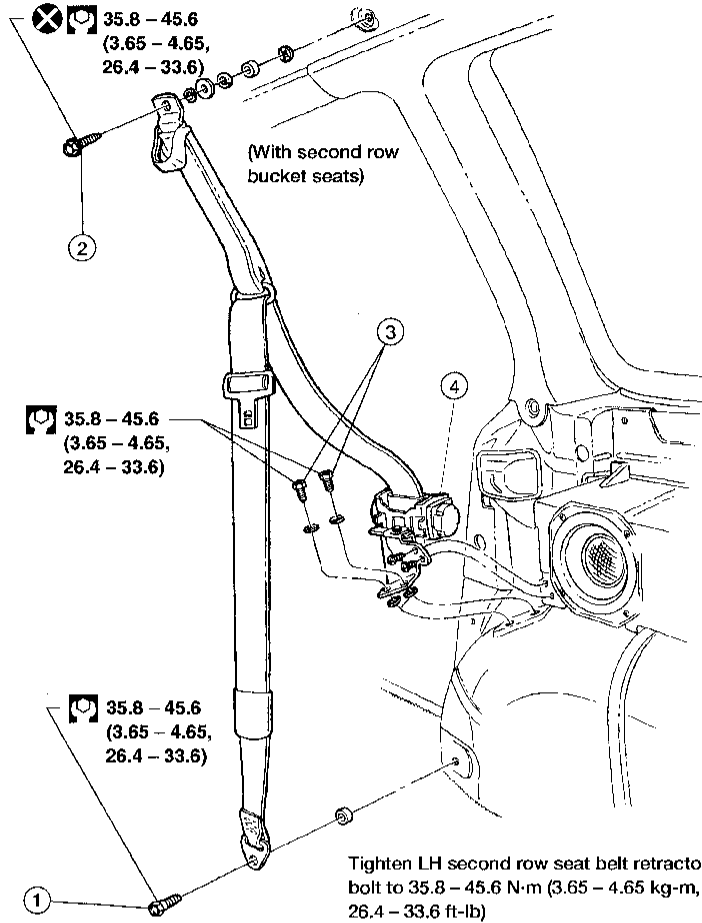
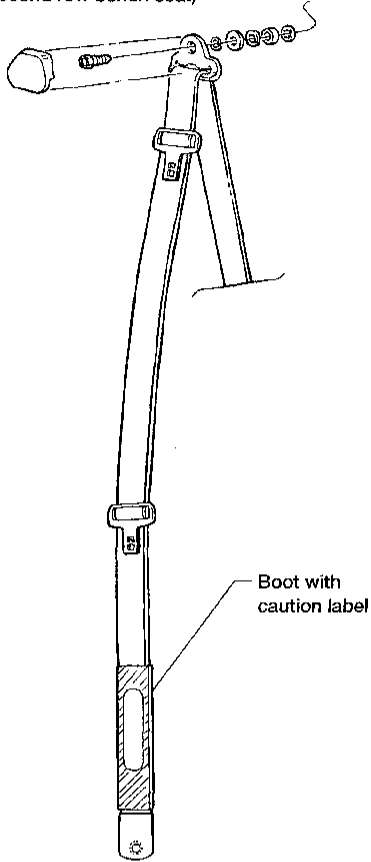

Third row seat belt retractor

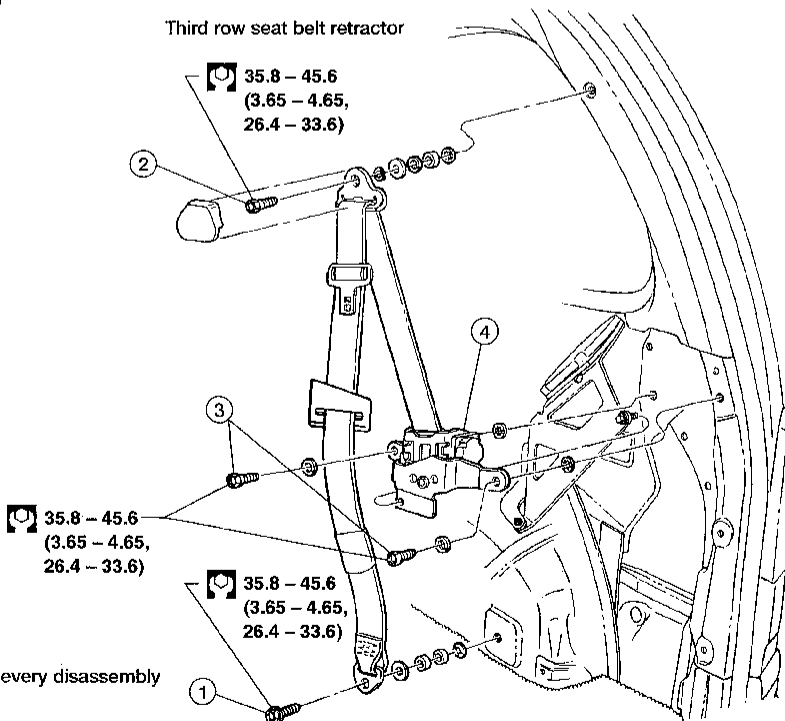

⊗ : Always replace after every disassembly

☑ : N·m (kg-m, ft-lb)

SEAT BELTS

Rear Seat Belts (Cont'd)

REMOVAL

- ① Remove lower seat belt anchor bolts.
Remove interior side trim. Refer to BT section (“Side and Floor Trim”, “INTERIOR TRIM”).
- ② Remove D-ring cover and D-ring anchor bolt.
- ③ Remove retractor bolts.
- ④ Remove retractor.

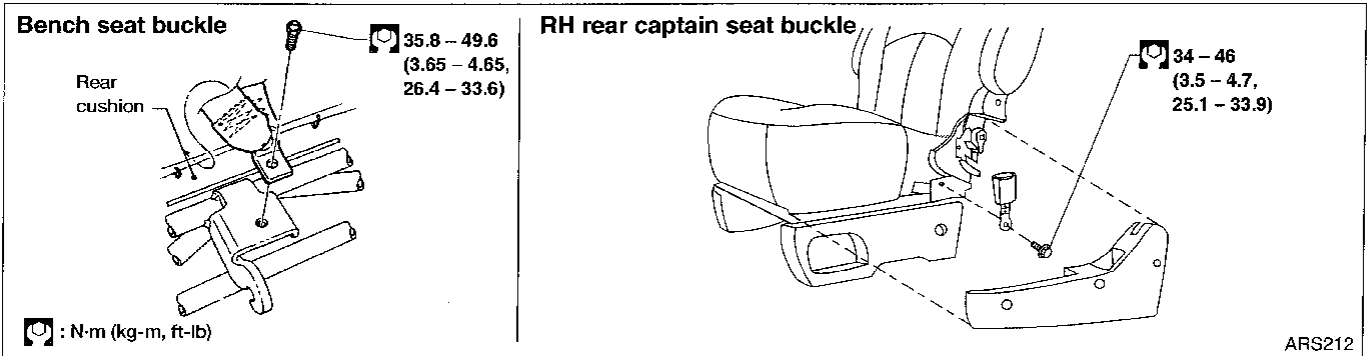

GI

MA

EM

LC

EC

FE

AT

FA

FA

BR

ST

RS

BT

HA

EL

IDX

SEAT BELTS

Built-In Child Seat

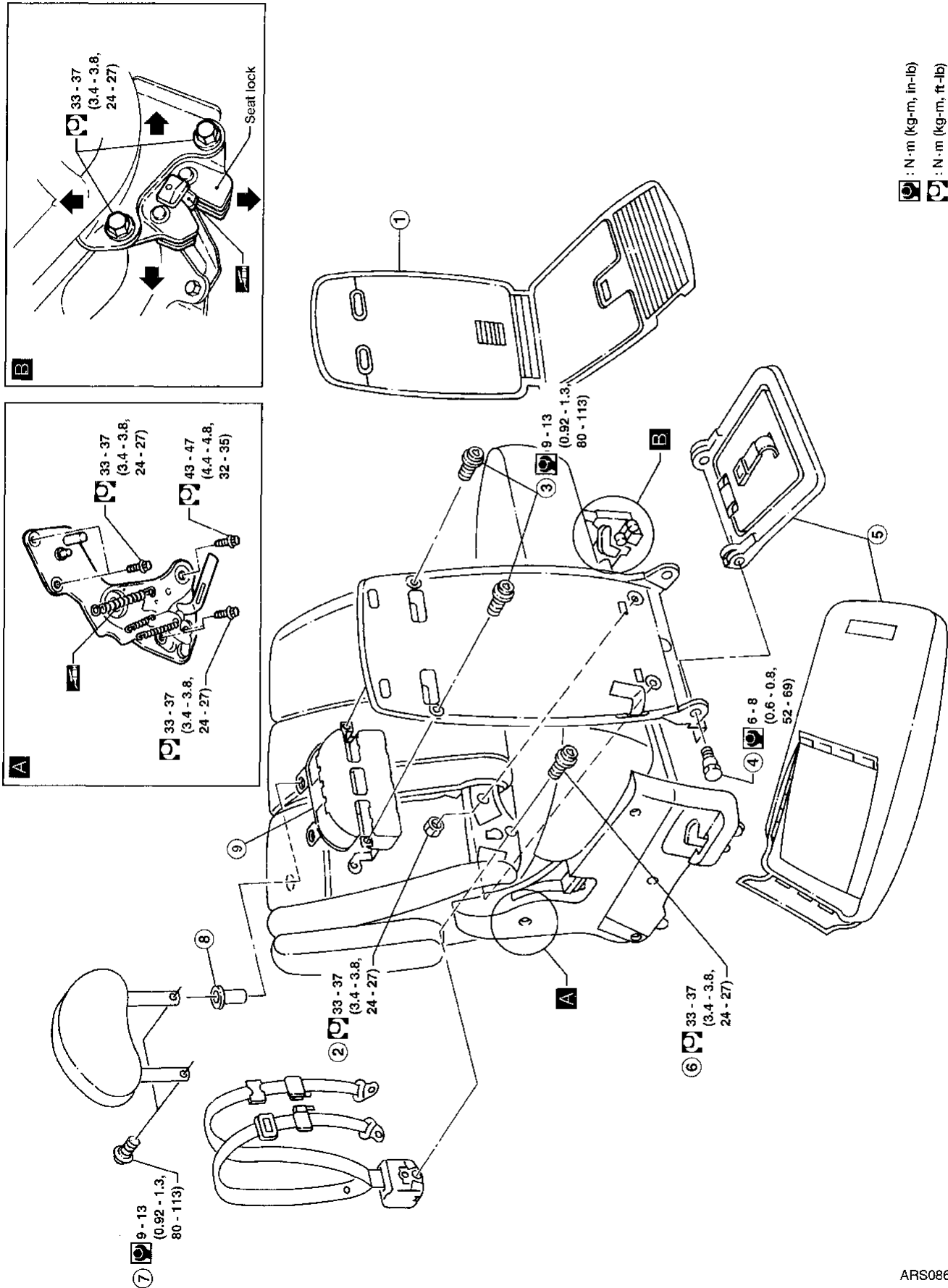

: N.m (kg-m, in-lb)
 : N.m (kg-m, ft-lb)
 : Lubricate with grease

SEAT BELTS

Built-In Child Seat (Cont'd)

SEAT BELT REMOVAL

- Remove seat back rear cover.
- ① Remove child seat pad. GI
 - ② Remove two nuts from rear of child seat back panel.
 - ③ Remove two screws from child seat back panel. Pull out seat back panel and cushion assembly.
 - ④ Remove two seat belt anchor bolts from sides of child seat. MA
 - ⑤ Remove child seat frame and cushion. To service frame and buckle or cushion, separate cushion from frame.
 - ⑥ Remove retractor bolt. To remove retractor, pull seat belts through seat back panel, energy absorber and seat frame. EM

HEADREST AND ENERGY ABSORBER REMOVAL

- Perform the steps listed above.
- ⑦ Remove two headrest screws. Use a file to deburr screwholes and remove headrest. LC
 - ⑧ Remove headrest bushings. EC
 - ⑨ Remove energy absorber from seat frame. FE

AT

FA

RA

BR

ST

RS

BT

HA

EL

IDX

SEAT BELTS

Seat Belt Inspection

AFTER A COLLISION

WARNING:

Inspect all seat belt assemblies including retractors and attaching hardware after any collision. NISSAN recommends that all seat belt assemblies in use during a collision be replaced unless the collision was minor and the belts show no damage and continue to operate properly. Failure to do so could result in serious personal injury in an accident. Seat belt assemblies not in use during a collision should also be replaced if either damage or improper operation is noted.

Replace any seat belt assembly if:

- The seat belt was in use at the time of a collision (except for minor collisions when the belts, retractors and buckles show no damage and continue to operate properly.)
- The seat belt was damaged in an accident (i.e. torn webbing, bent retractor or guide, etc.).
- The seat belt attaching point was damaged in an accident. Inspect the seat belt attaching area for damage or distortion and repair as necessary before installing a new seat belt assembly.

PRELIMINARY CHECKS

1. Check the seat belt warning lamp/chime for proper operation as follows:
 - a. Switch ignition ON. The seat belt warning lamp should illuminate. Also, the seat belt warning chime should sound for about seven seconds.
 - b. Fasten driver's seat belt. The seat belt warning lamp should go out and the chime (if sounding) should stop.
2. Check that the seat belt retractor, seat belt anchor and buckle bolts are securely attached.
3. Check the shoulder seat belt guide and shoulder belt height adjuster for front seats. Ensure guide swivels freely and that belt lays flat and does not bind in guide. Ensure height adjuster operates properly and holds securely.
4. Check retractor operation including:
 - a. Fully extend the seat belt webbing and check for twists, tears or other damage.
 - b. Allow the seat belt to retract. Ensure that belt returns smoothly and completely into the retractor. If the seat belt does not return smoothly, wipe the inside of the loops with a clean paper cloth, etc. because dirt built up in the loops of the upper anchors can cause the seat belts to retract slowly.

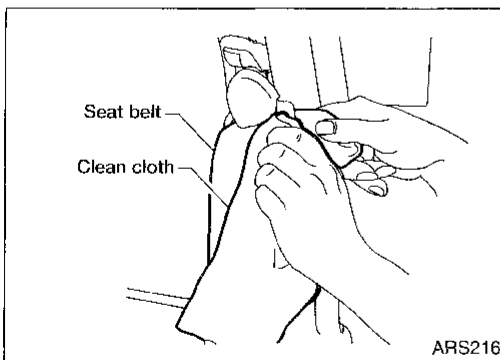

- c. Fasten the seat belt. Pull firmly on belt and buckle to ensure belt remains latched. Unfasten seat belt. Ensure belt releases freely and buckle button returns to original position.
5. For center (non-retractable) seat belts, check that the seat belts are accessible. Check seat belt webbing for twists, tears or other damage. Fasten the seat belt. Pull firmly on belt and buckle to ensure belt remains latched. Unfasten seat belts. Ensure belt releases freely and buckle button returns to original position.
 6. Repeat steps above as necessary to check the other seat belts.

SEAT BELTS

Seat Belt Inspection (Cont'd)

SEAT BELT RETRACTOR ON-VEHICLE CHECK

Emergency locking retractors (ELR) and Automatic locking retractors (ALR)

NOTE:

All seat belt retractors are of the Emergency Locking (ELR) type. In an emergency (sudden stop) the retractor will lock and prevent the belt from extending any further. All outboard 3-point type seat belt retractors except the driver's seat belt also have an Automatic Locking (ALR) mode. The ALR mode (also called child restraint mode) is used when installing child seats in outboard seating positions. The ALR mode is activated when the seat belt is fully extended. When the belt is then retracted partially, the ALR mode automatically locks the seat belt in a specific position so the belt cannot be extended any further. To cancel the ALR mode, allow the seat belt to fully wind back into the retractor.

Check the seat belt retractors using the following test(s) to determine if a retractor assembly is operating properly.

ELR function stationary check

Grasp the shoulder belt and pull forward quickly. The retractor should lock and prevent the belt from extending further.

ALR function stationary check

1. Pull out entire length of seat belt from retractor until a click is heard.
2. Retract the belt partially; a clicking noise should be heard as the belt retracts indicating retractor is in the automatic locking (ALR) mode.
3. Grasp the seat belt and try to pull out of retractor. Belt must lock and not extend further. If NG, replace the retractor assembly.
4. Allow the entire length of belt to retract to cancel the automatic locking mode.

ELR function moving check (all outboard seating positions)

WARNING:

Perform the following test in a safe, open area clear of other vehicles and obstructions (for example, a large, empty parking lot). Road surface must be paved and dry. DO NOT perform the following test on wet or gravel roads or on public streets and highways. This could result in an accident and serious personal injury. The driver and passenger must be prepared to brace themselves in the event the retractor does not lock.

1. Fasten driver's seat belt. Buckle a passenger into the seat for the belt that is to be tested.
2. Proceed to the designated safe area.
3. Drive the vehicle at approximately 16 km/h (10 mph). Notify any passengers of a pending sudden stop. The driver and passenger must be prepared to brace themselves in the event the retractor does not lock. Apply brakes firmly and make a very hard stop.

During stop, seat belts should lock and not extend. If the seat belt retractor assembly does not lock, perform the retractor off-vehicle check.

SEAT BELTS

Seat Belt Inspection (Cont'd)

SEAT BELT RETRACTOR OFF-VEHICLE CHECK

1. Remove the seat belt retractor assembly.
2. Slowly pull out belt while tilting the retractor assembly forward from the mounted position as shown in the illustration.

15 degrees or less tilt: Belt can be pulled out.

35 degrees or more tilt: Belt locks and cannot be pulled out.

Ex. (Details differ among models.)

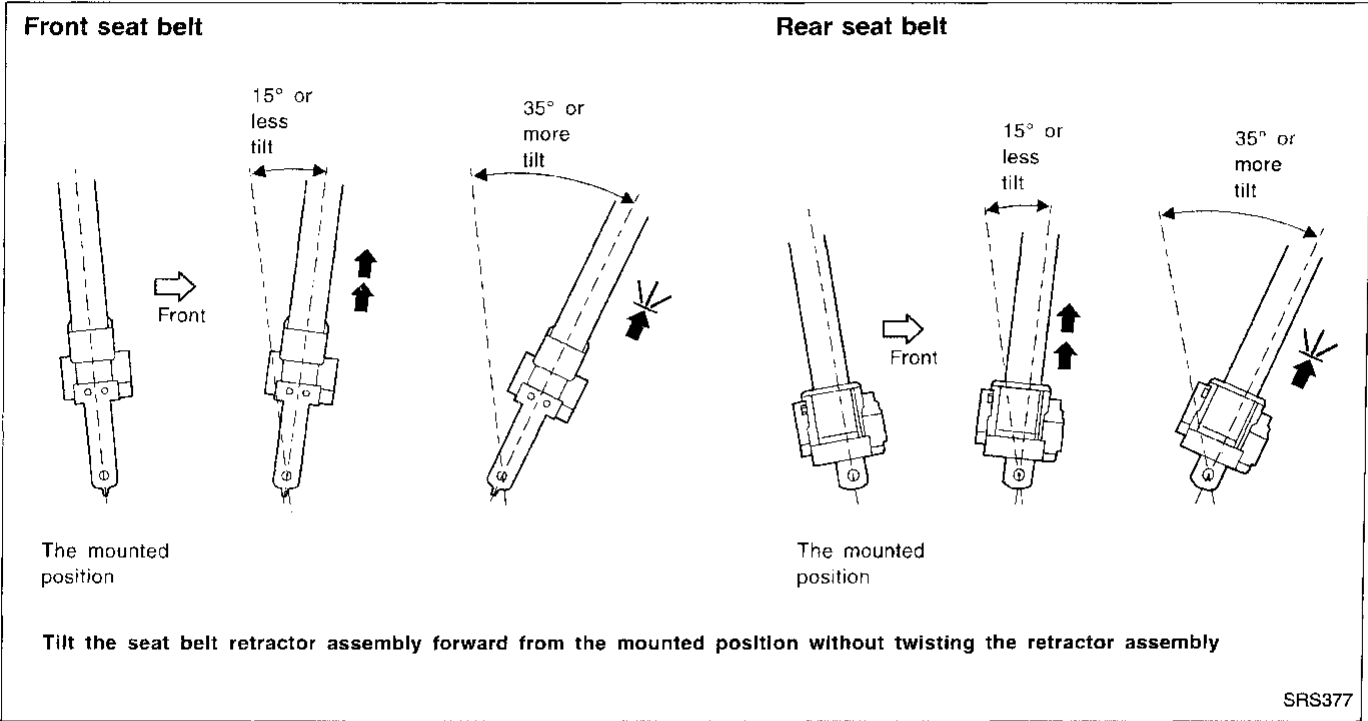

If NG replace the retractor assembly.

SUPPLEMENTAL RESTRAINT SYSTEM (SRS)

Precautions for SRS "Air Bag" Service

- Do not use electrical test equipment on any circuit related to the SRS unless instructed to in this Service Manual. SRS wiring harnesses are covered with yellow insulation either just before the harness connectors or over the complete harness for easy identification.
- Before servicing the SRS, turn ignition switch OFF, disconnect both battery cables and wait at least 3 minutes.
For approximately 3 minutes after the cables are removed, it is still possible for the air bag to deploy. Therefore, do not work on any air bag system connectors or wires until at least 3 minutes have passed.
- Diagnosis sensor unit must always be installed with arrow mark "↻" pointing towards the front of the vehicle for proper operation. Also check diagnosis sensor unit for cracks, deformities or rust before installation and replace as required.
- The spiral cable must be aligned with the neutral position since its rotations are limited. Do not attempt to turn steering wheel or column after removal of steering gear.
- Handle air bag modules carefully. Always place them with the pad side facing upward.
- Conduct self-diagnosis to check entire SRS for proper function.
- Do not use old bolts after removing any SRS parts, replace with new bolts.
- After air bag inflates, the instrument panel assembly should be replaced if damaged.

Special Service Tools

The actual shapes of Kent-Moore tools may differ from those of special service tools illustrated here.

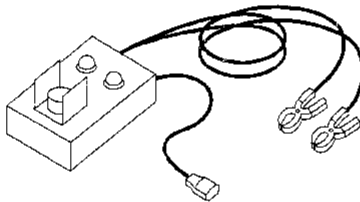
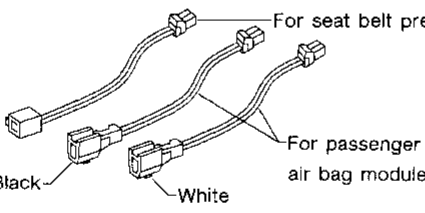
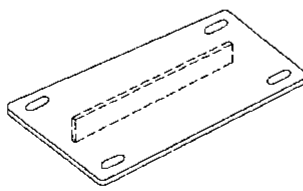
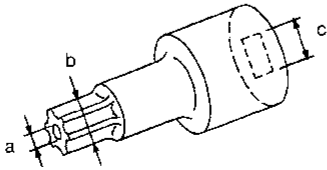
Tool number (Kent-Moore No.) Tool name	Description
KV991072S0 (J38381-KIT) Air bag deployment kit KV99106400 (J38381) Deployment tool	 <p style="text-align: right;">Disposing of air bag module</p> <p style="text-align: left;">NT357</p>
KV991065S0 (J38381-30) Deployment tool adapters	 <p style="text-align: right;">For seat belt pre-tensioner</p> <p style="text-align: right;">For passenger air bag module</p> <p style="text-align: left;">Black</p> <p style="text-align: left;">White</p> <p style="text-align: left;">NT353</p>
KV99105300 (J41246) Air bag module bracket	 <p style="text-align: right;">Anchor the air bag module</p> <p style="text-align: left;">NT354</p>
HT61961000 and HT62152000 combined (J38219) *Special torx bit	 <p style="text-align: right;">Use for special bolts [TAMPER RESISTANT TORX (Size T50)]</p> <p style="text-align: right;">a: 3.5 (0.138) dia. b: 8.5 - 8.6 (0.335 - 0.339) dia. c: approx. 10 (0.39) sq.</p> <p style="text-align: left;">NT361</p>

Unit: mm (in)

*: Special tool or commercial equivalent

SUPPLEMENTAL RESTRAINT SYSTEM (SRS)

Description

The air bags deploy if the diagnosis sensor unit activates while the ignition switch is in the ON or START position.

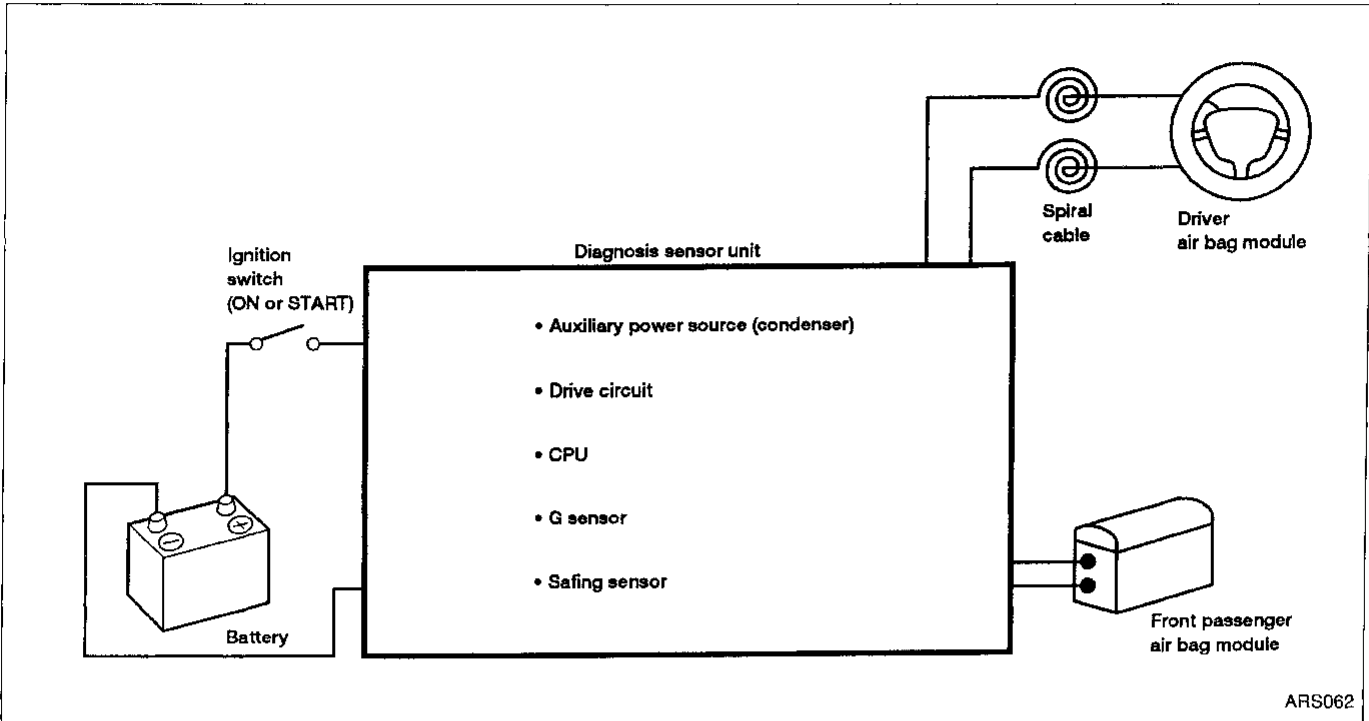

SRS Component Parts Location

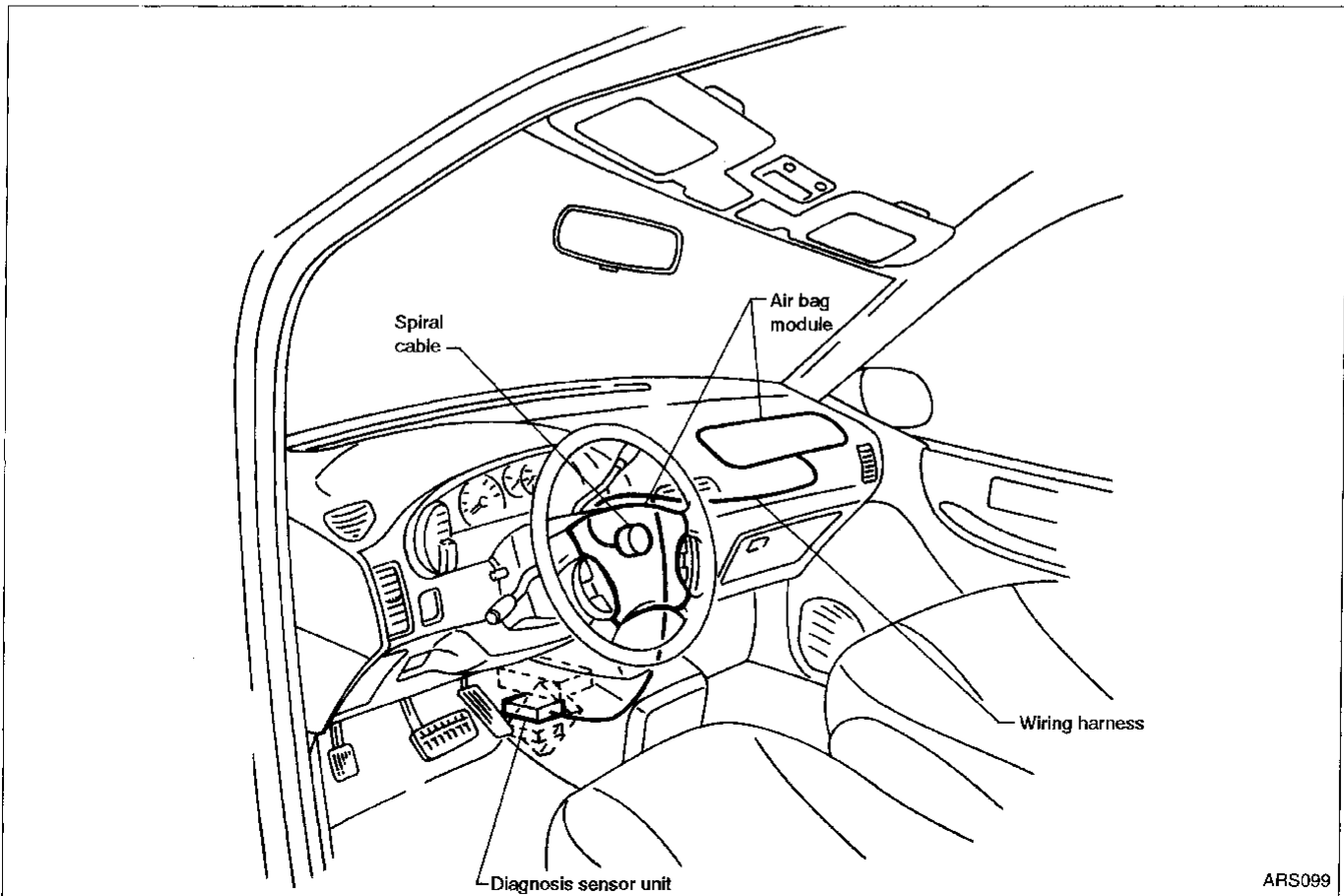

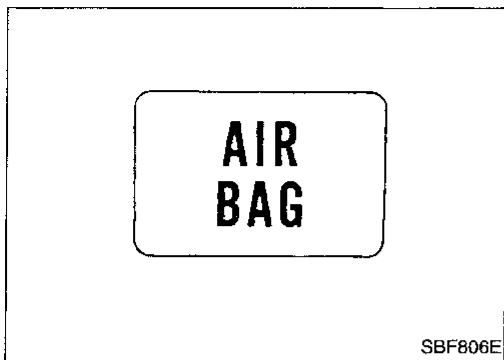

Maintenance Items

1. Check "AIR BAG" warning lamp operation
 After turning the ignition key ON, "AIR BAG" warning lamp illuminates. The "AIR BAG" warning lamp will turn off after about 7 seconds if no malfunction is detected.

If any of the following "AIR BAG" warning lamp conditions occur, immediately check the air bag system. Refer to RS-31.

- The warning lamp does not illuminate when the ignition switch is turned ON.
- The warning lamp does not turn off about 7 seconds after the ignition switch is turned ON.
- The warning lamp turns on or blinks about 7 seconds after the ignition switch is turned ON.

2. Visually check SRS components

(a) Diagnosis sensor unit

- Check diagnosis sensor unit and bracket for dents, cracks and deformities.
- Check connectors for damage, and terminals for deformities.

(b) Air bag module and steering wheel

- Remove air bag module from steering wheel or instrument panel. Check harness cover and connectors for damage, terminals for deformities, and harness for binding.
- Install driver air bag module in the steering wheel to check fit and alignment.
- Check steering wheel for excessive free play.
- Install passenger air bag module in the instrument panel to check fit and alignment.

(c) Spiral cable

- Check spiral cable and combination switch for damage.
- Check connectors and protective tape for damage.
- Check steering wheel for noise, binding and heavy operation.

(d) Main harness and air bag harness

- Check connectors for poor connections, damage, and terminals for deformities.
- Check harnesses for binding, chafing and cuts.

CAUTION:

Replace previously used special bolts, nuts and ground bolt with new ones.

GI

MA

EM

LC

EC

FE

AT

FA

RA

BR

ST

RS

BT

HA

EL

IDX

Diagnosis Sensor Unit

CAUTION:

- Before servicing SRS, turn the ignition switch OFF, disconnect both battery cables and wait at least 3 minutes.
- The special bolts are coated with a bonding agent while the other bolt is for ground. Do not use old bolts after removal; replace with new bolts.
- Check diagnosis sensor unit for proper installation.
- Check diagnosis sensor unit to ensure that there are no deformities, dents, cracks or rust. If there are any visible signs of damage, replace with a new one.
- Check diagnosis sensor unit brackets to ensure they are free of deformities or rust.
- Replace diagnosis sensor unit if it has been dropped or sustained an impact.

REMOVAL AND INSTALLATION

1. Disconnect driver and front passenger air bag module connectors.
2. Remove console box or CD magazine. Refer to BT section ("INSTRUMENT PANEL").
3. Disconnect and remove ABS control unit. Refer to BR section ("Removal and Installation", "ANTI-LOCK BRAKE SYSTEM").
4. Disconnect diagnosis sensor unit connector.
5. Remove bolts from diagnosis sensor unit. Use TAMPER RESISTANT TORX (Size T50) to remove special bolts.
6. Remove the diagnosis sensor unit.

NOTE:

- To install, reverse the removal procedure sequence.
- After replacement, perform self-diagnosis for SRS. Refer to "TROUBLE DIAGNOSES — Supplemental Restraint System (SRS)", "Self-diagnosis" RS-31.

CAUTION:

Diagnosis sensor unit must always be installed with arrow marks "↖" pointing towards the front of the vehicle for proper operation. Also check diagnosis sensor unit for cracks, deformities or rust before installation and replace as required.

SUPPLEMENTAL RESTRAINT SYSTEM (SRS)

Diagnosis Sensor Unit (Cont'd)

SEC. 253

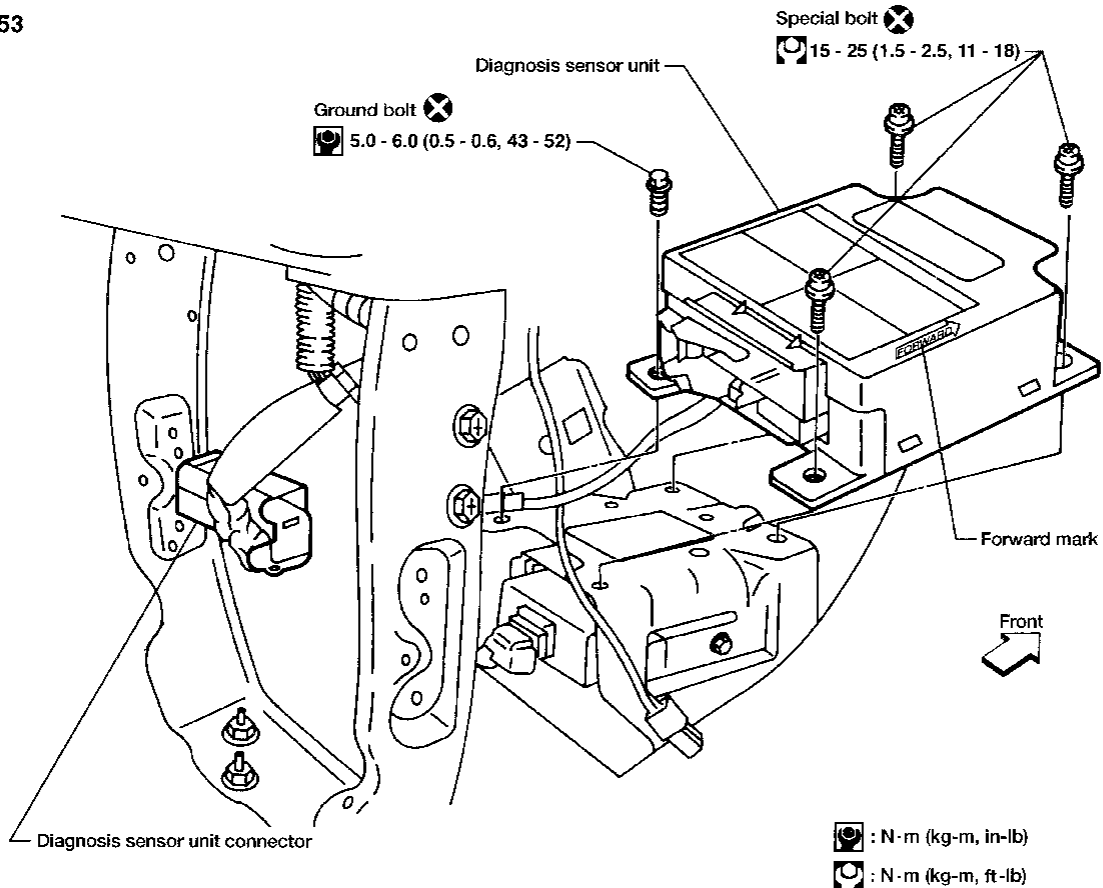

ARS098

GI
MA
EM
LC
EC
FE
AT
FA
RA
BR
ST
RS
BT
HA
EL
IDX

Driver Air Bag Module and Spiral Cable

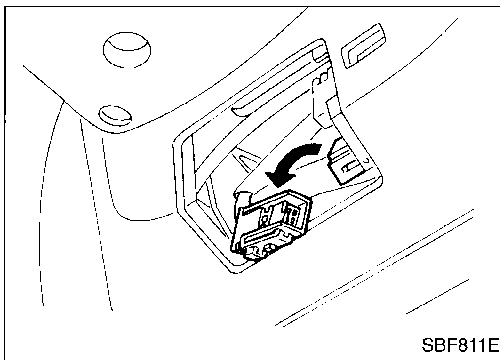
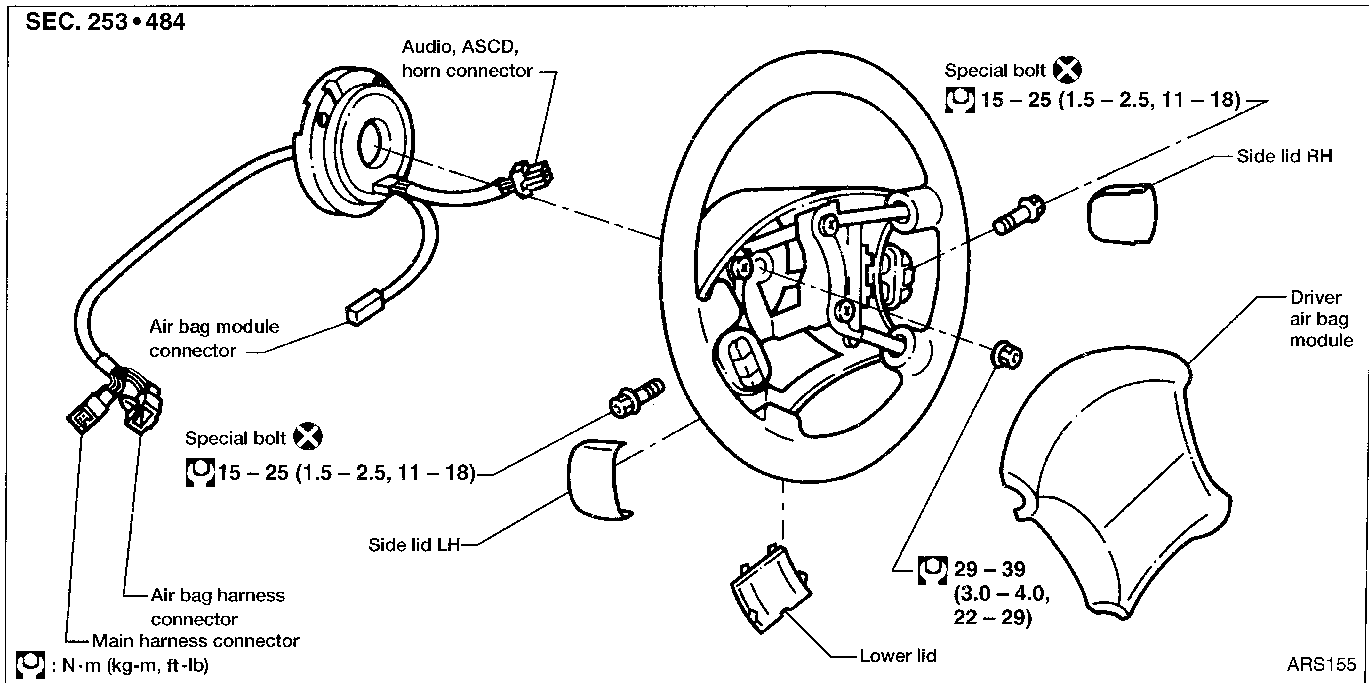

REMOVAL

CAUTION:

- Before servicing SRS, turn the ignition switch off, disconnect both battery cables and wait at least 3 minutes.
- Always work from the side of air bag module.

1. Remove lower lid from steering wheel, and disconnect driver air bag module connector.

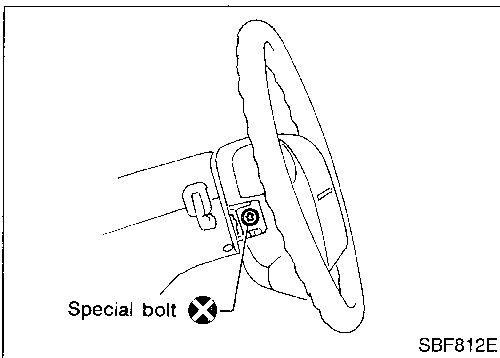

2. Remove side lids. Using the TAMPER RESISTANT TORX (Size T50), remove left and right special bolts. Driver air bag module can then be removed.

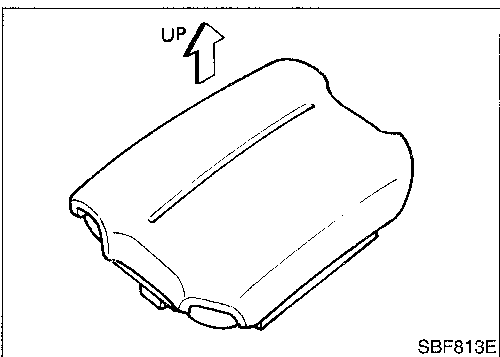

CAUTION:

- Always place air bag module with pad side facing upward.
- Do not attempt to disassemble air bag module.
- The special bolts are coated with a bonding agent. Do not use old bolts after removal; replace with new coated bolts.
- Do not insert any foreign objects (screwdriver, etc.) into air bag module connector.

SUPPLEMENTAL RESTRAINT SYSTEM (SRS)

Driver Air Bag Module and Spiral Cable (Cont'd)



- Do not drop or impact air bag module. Replace air bag module if it has been dropped or sustained an impact.
- Do not expose the air bag module to temperatures exceeding 90°C (194°F).
- Do not allow oil, grease or water to come in contact with the air bag module.

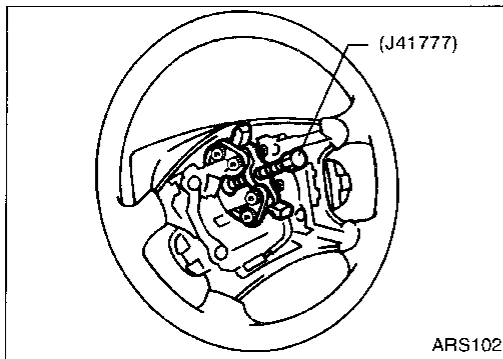

3. Set steering wheel in the neutral position.
4. Disconnect horn connector and remove steering wheel nut.
5. Using steering wheel puller, remove steering wheel. Be careful not to over-tighten puller bolt on steering wheel.

CAUTION:

Do not tap or bump the steering wheel.

6. Remove steering column cover.
7. Disconnect air bag harness and main harness connectors.

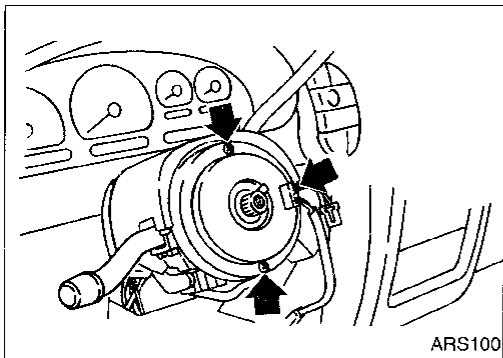

8. Remove the three screws. The spiral cable can then be removed.

CAUTION:

- Do not attempt to disassemble spiral cable.
- Do not apply lubricant to the spiral cable.

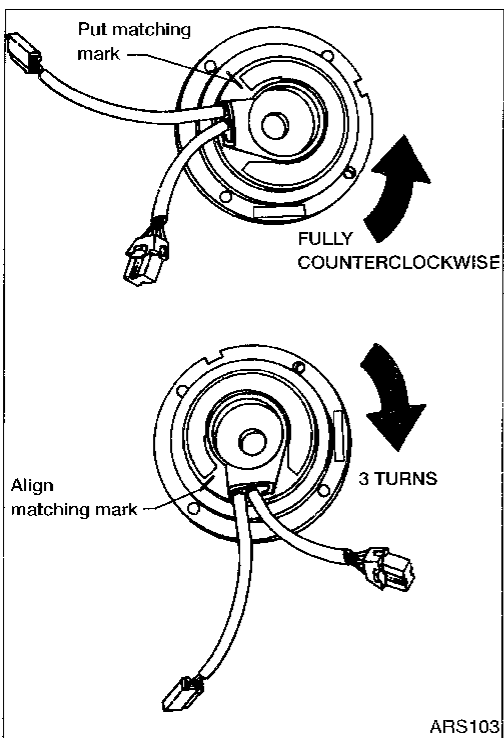

INSTALLATION

1. Set the front wheels in the straight-ahead position.
2. Rotate the spiral cable fully counterclockwise until tight and put matching marks on the inner and outer portions.
3. Rotate the spiral cable 3 turns clockwise and align the matching marks. Then install the spiral cable.

Use tape to hold the spiral cable in this position while installing.

CAUTION:

- The spiral cable may snap during steering wheel operation if the spiral cable is installed improperly.
 - With the steering linkage disconnected, the cable may snap by turning the steering wheel beyond the limited number of turns. The spiral cable can be turned up to 3 turns from the neutral position to both the left and right.
4. Connect spiral cable air bag harness and main harness connectors and tighten screws. Install steering column cover.

SUPPLEMENTAL RESTRAINT SYSTEM (SRS)

Driver Air Bag Module and Spiral Cable (Cont'd)

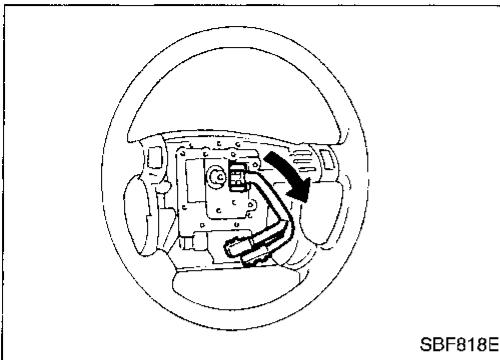

5. Install steering wheel and pull spiral cable harness through.
6. Connect horn connector.
7. Tighten steering wheel nut.

: 29 - 39 N·m (3.0 - 4.0 kg-m, 22 - 29 ft-lb)

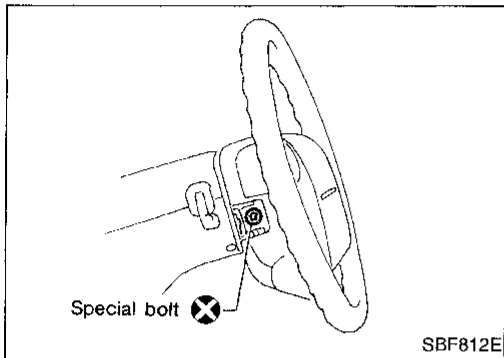

8. Position driver air bag module and tighten with new special bolts.
9. Connect driver air bag module connector.
10. Install all lids.
11. Connect both battery cables.
12. Conduct Self-diagnosis to ensure entire SRS operates properly. (Use CONSULT or warning lamp check.)
Turn steering wheel to the left end and then to the right end fully to make sure that spiral cable is set in the neutral position.
13. If "AIR BAG" warning lamp blinks (in User mode), it shows that the spiral cable may be snapped due to its improper position. Perform self-diagnosis again (Use CONSULT or warning lamp check). If a malfunction is detected, replace the spiral cable with a new one.
14. Perform self-diagnosis again to check that no malfunction is detected.

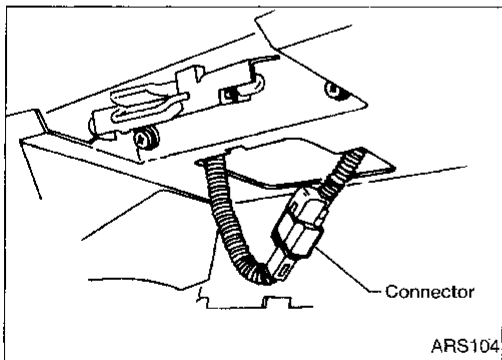

Front Passenger Air Bag Module

REMOVAL

CAUTION:

- Before servicing SRS, turn the ignition switch off, disconnect both battery cables and wait at least 3 minutes.
 - Always work from the side of or under air bag module.
1. Remove access panel behind glove box and disconnect front passenger air bag module connector.
 2. Remove glove box assembly.

SUPPLEMENTAL RESTRAINT SYSTEM (SRS)

Front Passenger Air Bag Module (Cont'd)

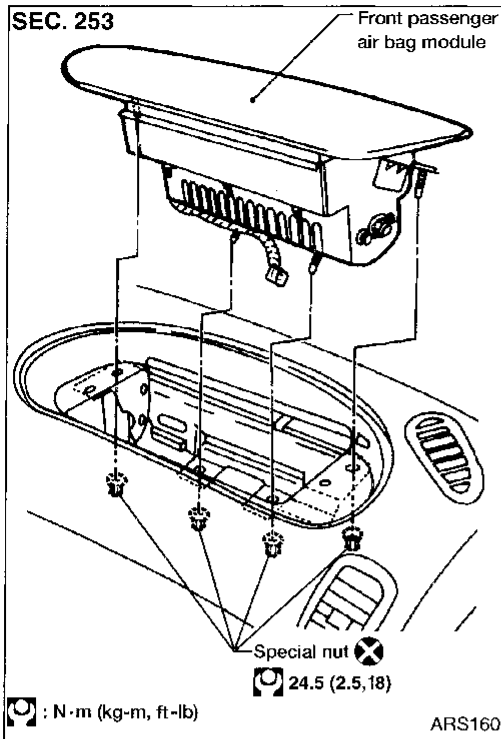

3. Remove four special nuts.
 4. Remove front passenger air bag module.
- Air bag module is heavy and should be supported using both hands during removal.

CAUTION:

- Always place air bag module with pad side facing upward.
- Do not attempt to disassemble air bag module.
- The special nuts are coated with a bonding agent. Do not use old nuts after removal; replace with new coated nuts.
- Do not insert any foreign objects (screwdriver, etc.) into air bag module connector.



- Do not drop or impact air bag module. Replace air bag module if it has been dropped or sustained an impact.
- Do not expose the air bag module to temperatures exceeding 90°C (194°F).
- Do not allow oil, grease or water to come in contact with the air bag module.
- After air bag inflates, the instrument panel should be replaced if damaged.

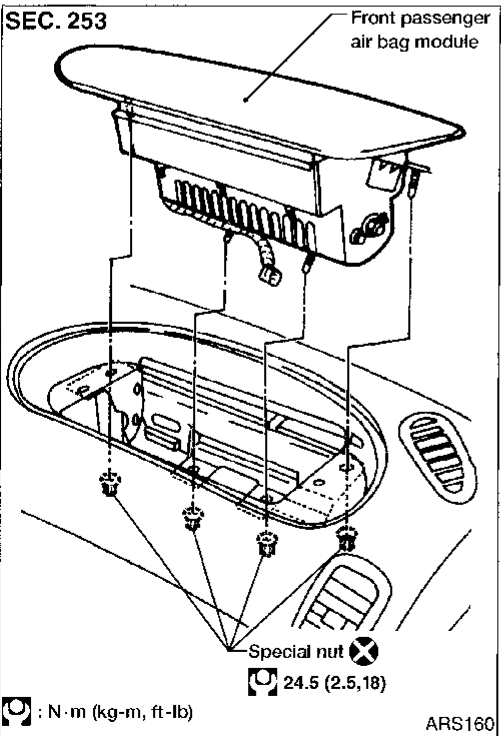

INSTALLATION

1. Install front passenger air bag module in instrument panel.
2. Connect front passenger air bag module connector to air bag harness.
3. Install glove box assembly and access panel.

Disposal of Air Bag Module

- Make sure to deactivate air bag modules before disposing of them. Also, before disposing of a vehicle equipped with an air bag system, deactivate air bag modules. If such a system has already been deployed due to an accident, dispose of as indicated in the section “DISPOSING OF AIR BAG MODULE”, RS-25.
- Do not dispose of the air bag module undeployed.
- When deploying the air bag module, always use the Special Service Tool; Deployment tool (Kent-Moore No. J38381).
- When deploying the air bag module, stand at least 5 m (16 ft) away from the air bag module.
- When deploying air bag module, a fairly loud noise occurs, followed by smoke being released. The smoke is not poisonous, however, be careful not to inhale smoke since it irritates throat and can cause choking.
- Always activate one air bag module at a time.
- Due to heat, do not touch air bag module for at least 30 minutes after deployment.
- Be sure to wear gloves when handling a deployed air bag module.
- Never apply water to a deployed air bag module.
- Wash your hands after finishing work.
- Place vehicle outdoors with at least 6 m (20 ft) of open space on all sides when deploying air bag module while mounted in vehicle.
- Use a voltmeter to make sure the vehicle battery is fully charged.

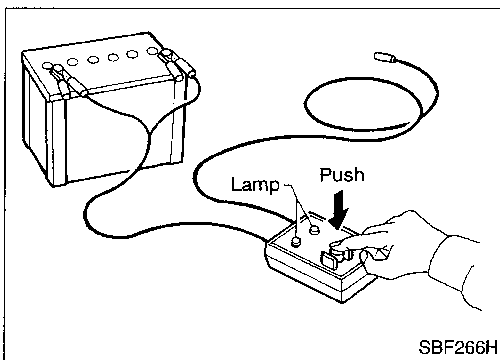
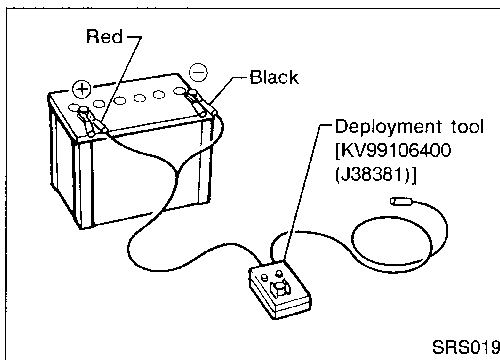

CHECKING DEPLOYMENT TOOL

Connecting to battery

CAUTION:

The battery must show voltage of 9.6V or more.

Remove the battery from the vehicle and place it on dry wood blocks approximately 5 m (16 ft) away from the vehicle.

- Wait 3 minutes after the vehicle battery is disconnected before proceeding.
- Connect red clip of deployment tool to battery positive terminal and black clip to negative terminal.

CAUTION:

Make sure the polarity is correct. The right side lamp in the tool, marked “deployment tool power”, should glow with a green light. If the right side lamp glows red, reverse the connections to the battery.

Deployment tool check

Press the deployment tool switch to the ON position. The left side lamp in the tool, marked “air bag connector voltage” should illuminate. If it does not illuminate, replace the tool.

Air bag deployment tool lamp illumination chart (Battery connected)

Switch operation	Left side lamp, green* “AIR BAG CONNecTOR VOLTAGE”	Right side lamp, green* “DEPLOYMENT TOOL POWER”
OFF	OFF	ON
ON	ON	ON

*: If this lamp glows red, the tool is connected to the battery incorrectly. Reverse the connections and make sure the lamp glows green.

SUPPLEMENTAL RESTRAINT SYSTEM (SRS)

Disposal of Air Bag Module (Cont'd) DEPLOYMENT PROCEDURES FOR AIR BAG MODULE (Outside of vehicle)

Deploying air bag module while it is mounted in vehicle may damage vehicle. Deploy air bag module as a unit except when disposing of vehicle.

Anchor air bag module in a vise secured to a firm foundation during deployment.

GI
MA
EM

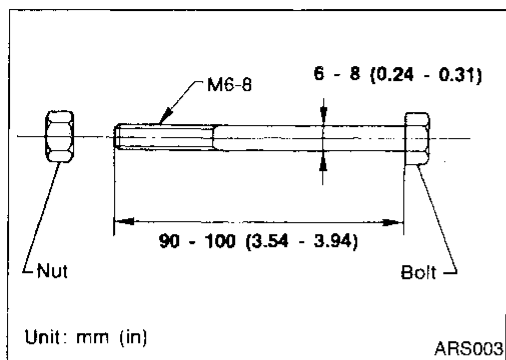

Deployment of driver air bag module (outside of vehicle)

1. Prepare two sets of nuts and bolts (see figure at left). These bolts are required to secure driver air bag module to the vise.
2. Install one set of nuts and bolts to each side of driver air bag module.

CAUTION:

Make sure to install a bolt and nut on each side.

LC
EC
FE
AT

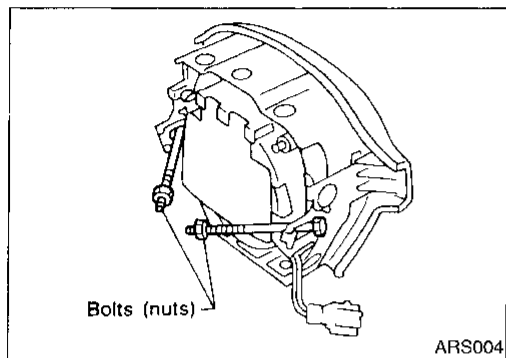

3. Firmly place two nuts (secured to driver air bag module) in the vise.

CAUTION:

Ensure that these two nuts are equally placed in the vise. Never finish the installation with just one nut.

4. Connect deployment tool (SST: J38381) to driver air bag module connector.

FA
RA
BR
ST

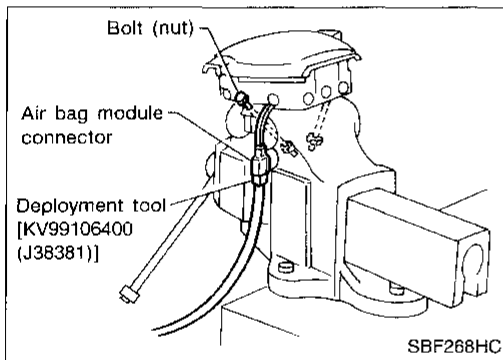

5. Connect red clip of deployment tool to battery positive terminal and black clip to negative terminal.

6. The lamp on the right side of the tool, marked "deployment tool power", should glow green, not red.

7. Press the button on the deployment tool. The left side lamp on the tool, marked "air bag connector voltage", will illuminate and the air bag module will deploy.

CAUTION:

When deploying the air bag module, stand at least 5 m (16 ft) away from the air bag module.

RS
BT
HA

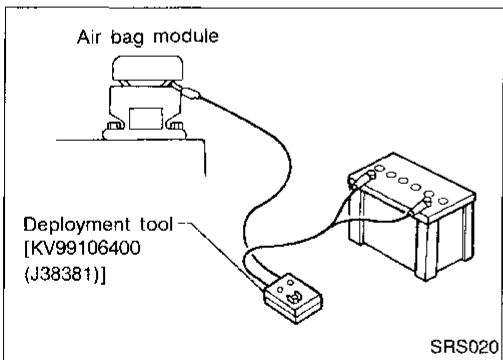

Deployment of front passenger air bag module (outside of vehicle)

1. Make an 8.5 mm (0.335 in) diameter hole in air bag module bracket (SST: J41246) at the position shown in figure at left.

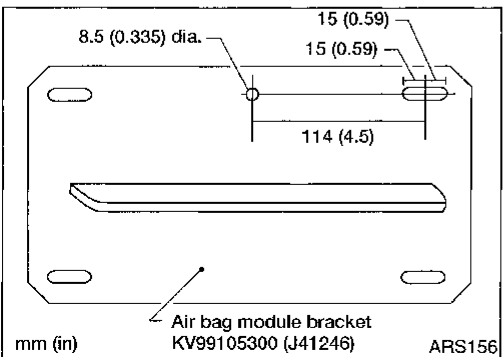

IDX

SUPPLEMENTAL RESTRAINT SYSTEM (SRS)

Disposal of Air Bag Module (Cont'd)

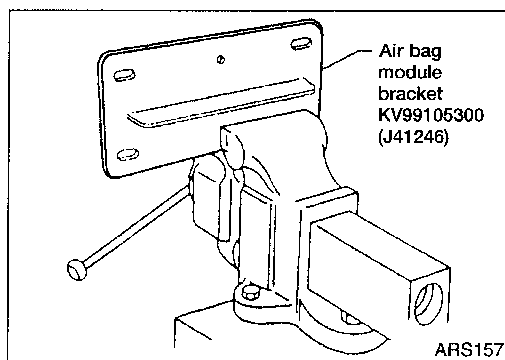

2. Firmly secure air bag module bracket (SST: J41246) in a vise as shown so that the bottom edge of bracket is even with bottom of vise jaws.

- Make sure vise is firmly secured and will not pivot.

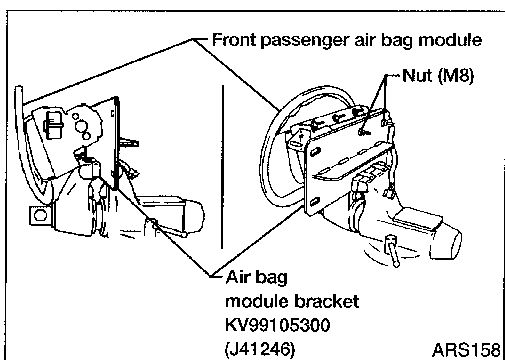

3. Match the two lower studs of front passenger air bag module to holes in air bag module bracket (held in vise) and fix both with nuts (M8). Tighten nuts securely.

CAUTION:

When mounting the air bag module, face pad side of air bag module to open area. Provide at least 2 m (7 ft) of clearance between pad side of air bag module and any object.

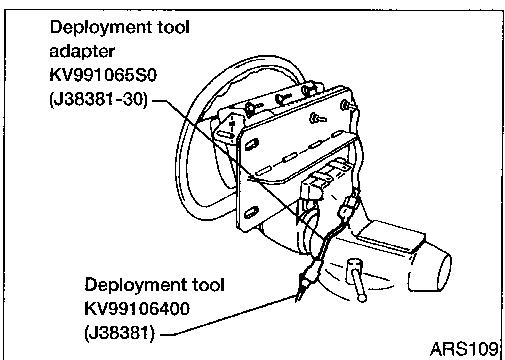

4. Connect deployment tool adapter (SST: J38381-30) to deployment tool (SST: J38381). Connect other end of deployment tool adapter to front passenger air bag module connector.

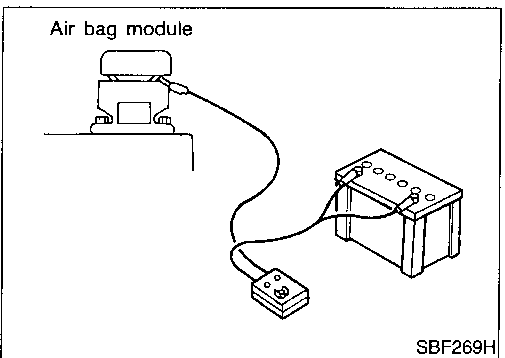

5. Connect red clip of deployment tool to battery positive terminal and black clip to negative terminal.
6. The lamp on the right side of the tool, marked "deployment tool power", should glow green, not red.
7. Press the button on the deployment tool. The left side lamp on the tool, marked "air bag connector voltage", will illuminate and the air bag module will deploy.

CAUTION:

When deploying the air bag module, stand to the side of the module at least 5 m (16 ft) away.

SUPPLEMENTAL RESTRAINT SYSTEM (SRS)

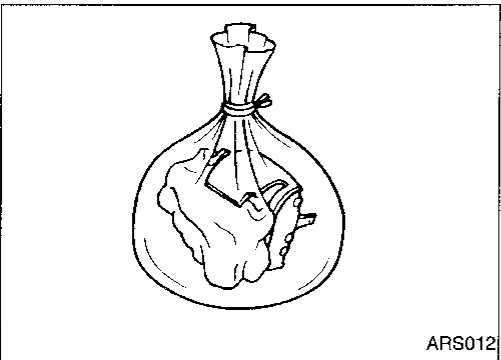
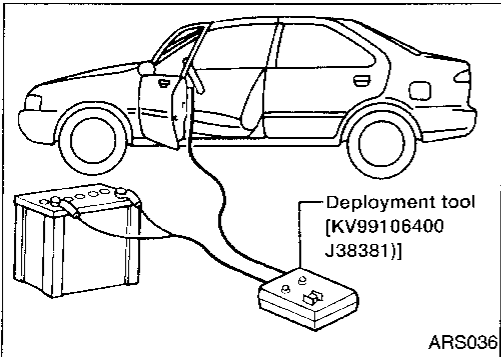
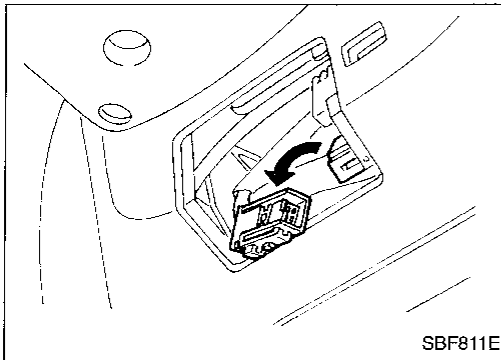

Disposal of Air Bag Module (Cont'd) DEPLOYMENT OF AIR BAG MODULE WHILE MOUNTED IN VEHICLE

When disposing of vehicles, deploy air bag module while it is mounted in vehicle.

CAUTION:

When deploying air bag module, ensure that the vehicle is empty.

1. Turn ignition switch OFF, disconnect both battery cables and wait at least 3 minutes.
2. Disconnect air bag module connector.
3. Connect deployment tool (SST: J38381) connector to air bag module.
For front passenger air bag module, use adapters (SST: J38381-30) to attach module to deployment tool connector.
4. Connect red clip of deployment tool to battery positive terminal and black clip to negative terminal.
5. The lamp on the right side of the tool, marked "deployment tool power", should glow green, not red.
6. Press the button on the deployment tool. The left side lamp on the tool, marked "air bag connector voltage", will illuminate. Then the air bag module will deploy.

DISPOSING OF AIR BAG MODULE

Deployed air bag module is very hot. Before disposing of air bag modules, wait at least 30 minutes. Seal them in a plastic bag before disposal.

CAUTION:

- Never apply water to a deployed air bag module.
- Be sure to wear gloves when handling a deployed air bag module.
- No poisonous gas is produced upon air bag module deployment. However, be careful not to inhale gas since it irritates the throat and can cause choking.
- Do not attempt to disassemble air bag module.
- Air bag module cannot be reused.
- Wash your hands after finishing work.

How to Perform Trouble Diagnoses for Quick and Accurate Repair

A good understanding of the malfunction conditions can make troubleshooting faster and more accurate. In general, each customer feels differently about a problem. It is important to fully understand the symptoms or conditions of a customer complaint.

INFORMATION FROM CUSTOMER

- WHAT Vehicle model
- WHEN Date, Frequencies
- WHERE Road conditions
- HOW Operating conditions, Symptoms

PRELIMINARY CHECK

Check that the following parts are in good order.

- Battery [Refer to EL section (“BATTERY”).]
- Fuse [Refer to EL section (“Fuse”, “POWER SUPPLY ROUTING”).]
- System component-to-harness connections

DIAGNOSIS FUNCTION

The SRS self-diagnosis results can be read by using “AIR BAG” warning lamp and/or CONSULT. The reading of these results is accomplished using one of two modes — “User mode” or “Diagnosis mode”. The User mode is exclusively prepared for the customer (driver). This mode warns the driver of a system malfunction through the operation of the “AIR BAG” warning lamp.

The Diagnosis mode allows the technician to locate and inspect the malfunctioning part.

The mode applications for the “AIR BAG” warning lamp and CONSULT are as follows:

	User mode	Diagnosis mode	Display type
“AIR BAG” warning lamp	X	X	ON-OFF operation
CONSULT	—	X	Monitoring

DIAGNOSIS MODE FOR CONSULT

- “SELF-DIAG [CURRENT]”
A current Self-diagnosis result (also indicated by the number of warning lamp flashes in the Diagnosis mode) is displayed on the CONSULT screen in real time. This refers to a malfunctioning part requiring repairs.
- “SELF-DIAG [PAST]”
Diagnosis results previously stored in the memory are displayed on the CONSULT screen. The stored results are not erased until memory erasing is executed.
- “TROUBLE DIAG RECORD”
With “TROUBLE DIAG RECORD”, diagnosis results previously erased by a reset operation can be displayed on the CONSULT screen.

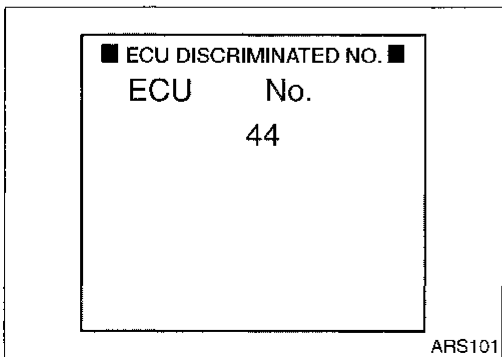

- “ECU DISCRIMINATED NO.”
The diagnosis sensor unit for each vehicle model is assigned with its own individual classification number. This number will be displayed on the CONSULT screen, as shown at left. When replacing the diagnosis sensor unit, refer to the part number for compatibility. After installation, replacement with a correct unit can be checked by confirming this classification number on the CONSULT screen.
For model V40, the diagnosis sensor unit classification number assigned is No. 44.

TROUBLE DIAGNOSES — Supplemental Restraint System (SRS)

How to Perform Trouble Diagnoses for Quick and Accurate Repair (Cont'd)

CAUTION:

- Do not use electrical test equipment on any circuit related to the SRS unless instructed to in this Service Manual. SRS wiring harnesses are covered with yellow insulation either just before the harness connectors or over the complete harness for easy identification.
- Do not attempt to repair, splice or modify the SRS wiring harness. If the harness is damaged, replace it with a new one.
- Keep ground portion clean.

WORK FLOW

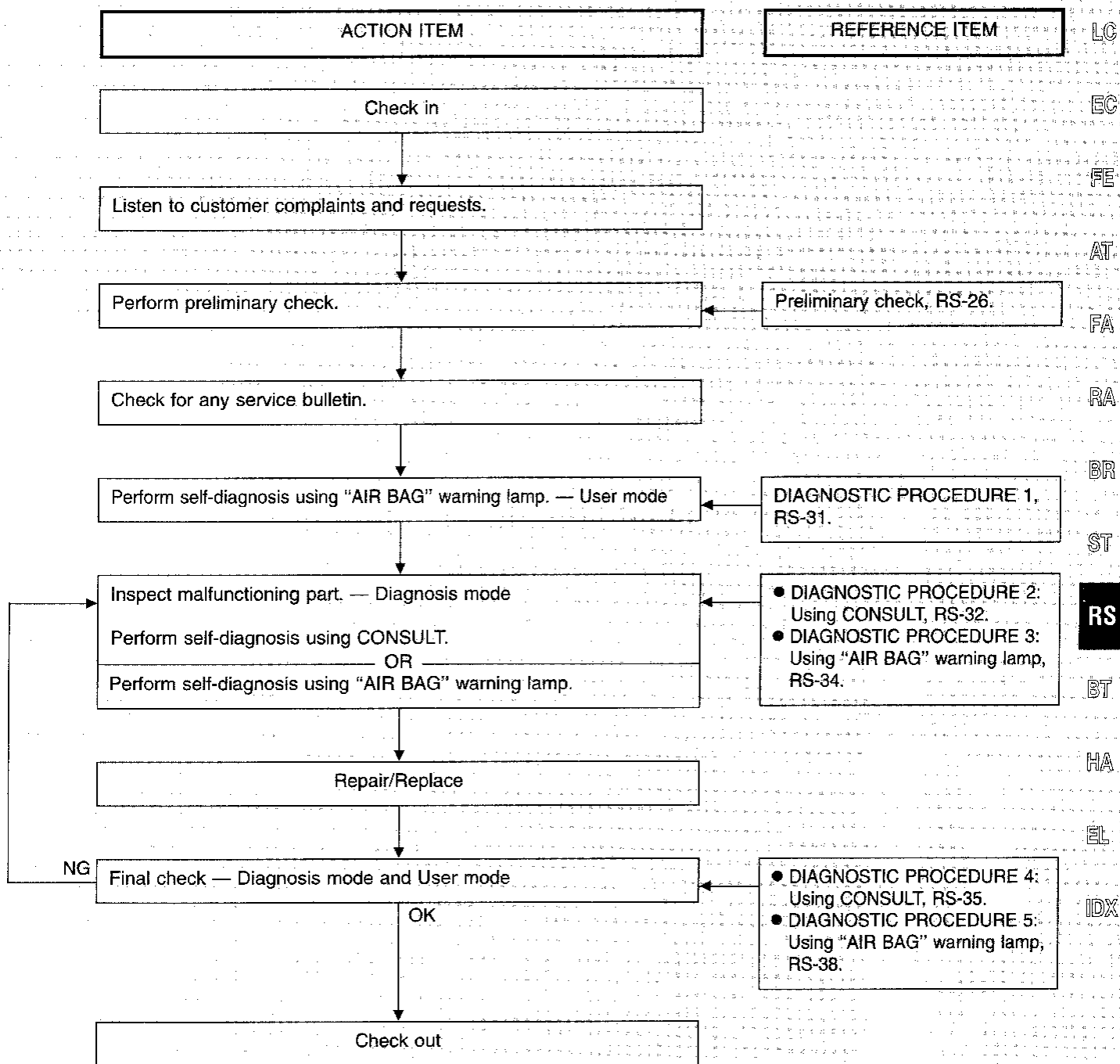

TROUBLE DIAGNOSES — Supplemental Restraint System (SRS)

Schematic

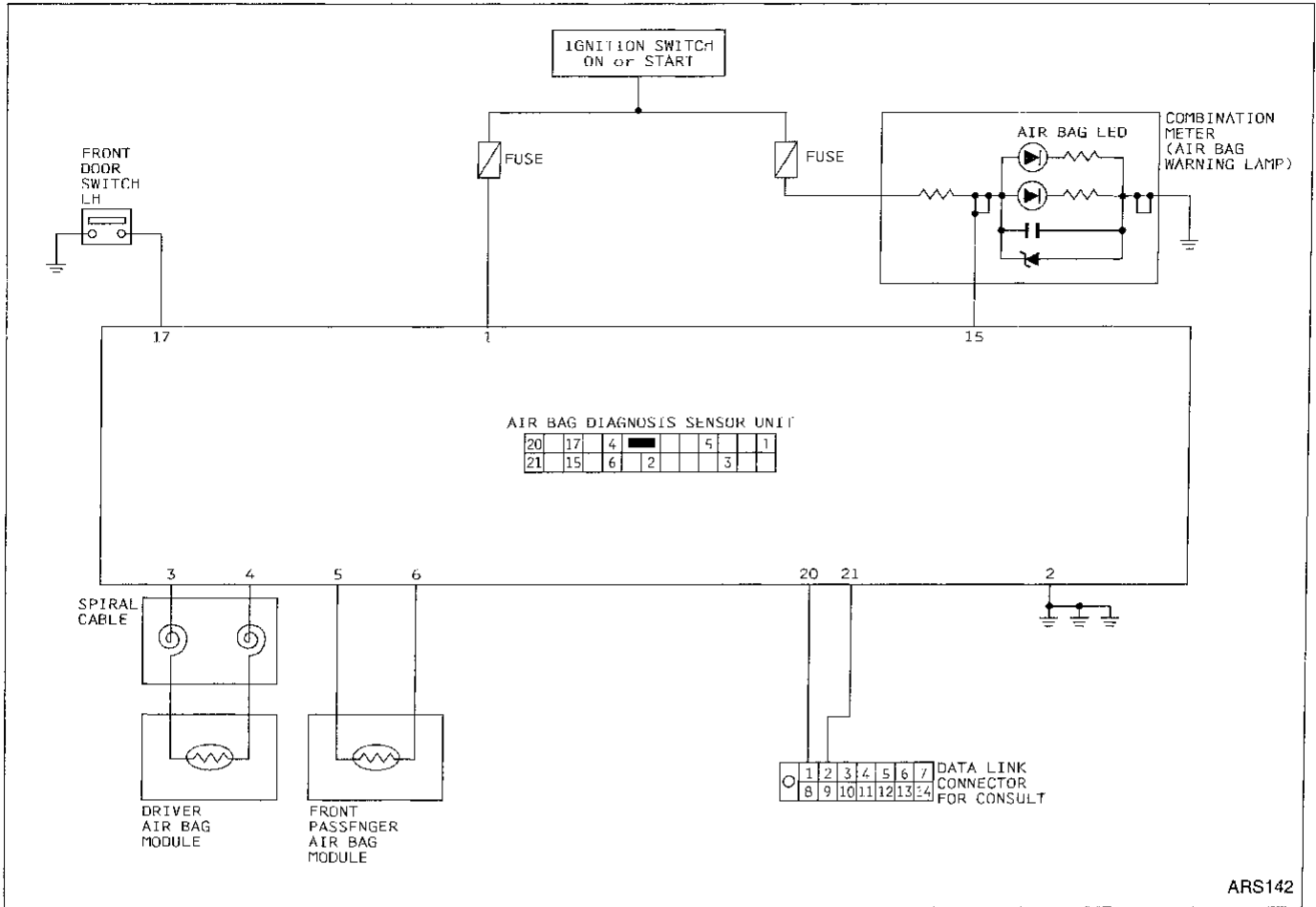

ARS142

Wiring Diagram -SRS-

RS-SRS-01

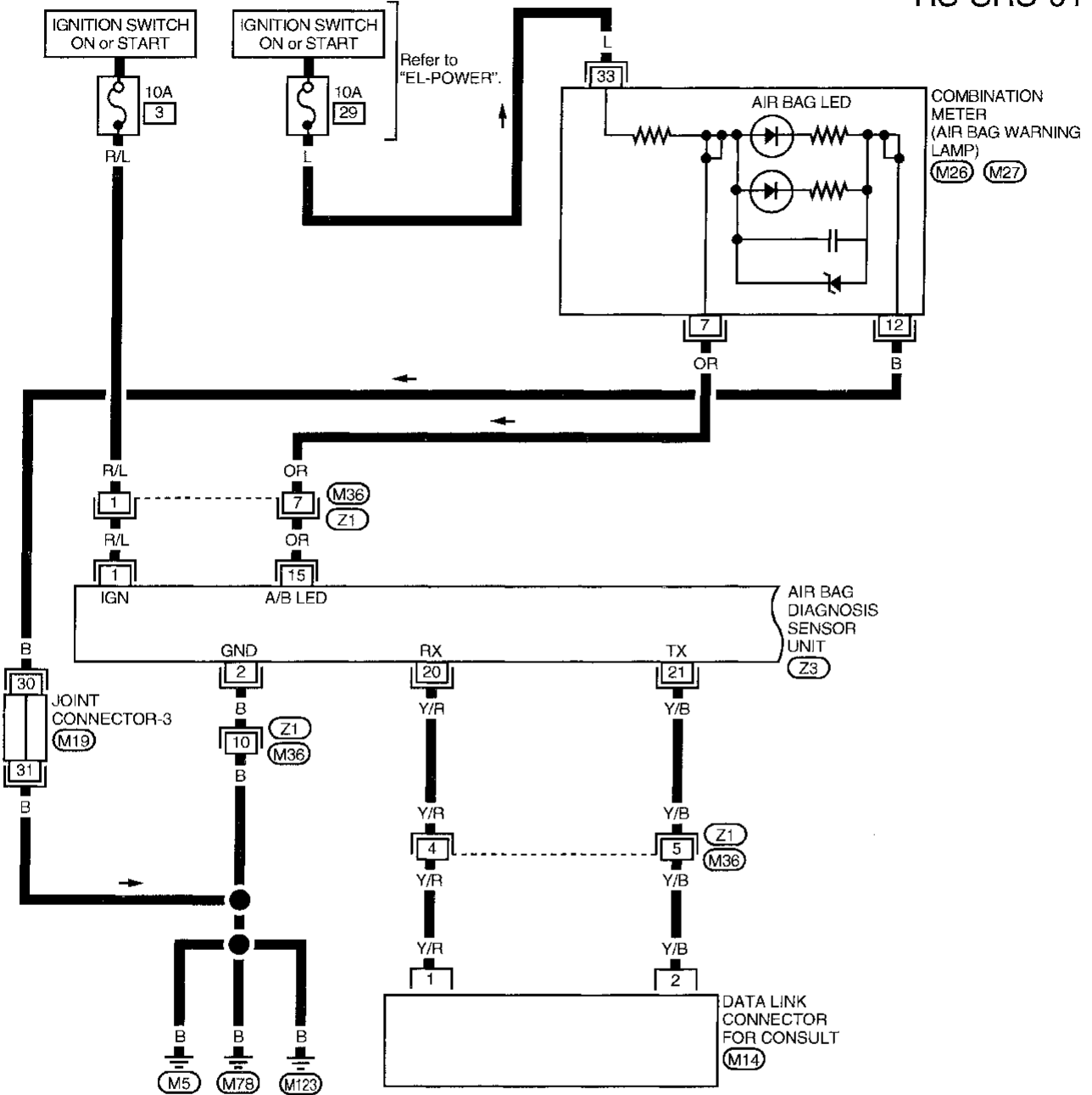

GI
MA
EM
LC
EC
FE
AT
FA
RA
BR
ST
RS
BT
HA
EL

Refer to last page (Foldout page).

(M19)

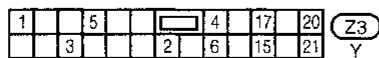
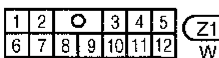
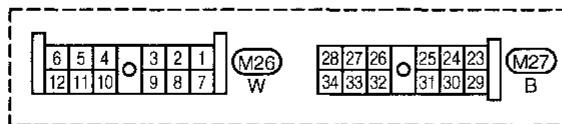
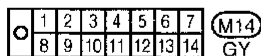

IDX

TROUBLE DIAGNOSES — Supplemental Restraint System (SRS)

Wiring Diagram –SRS– (Cont'd)

RS-SRS-02

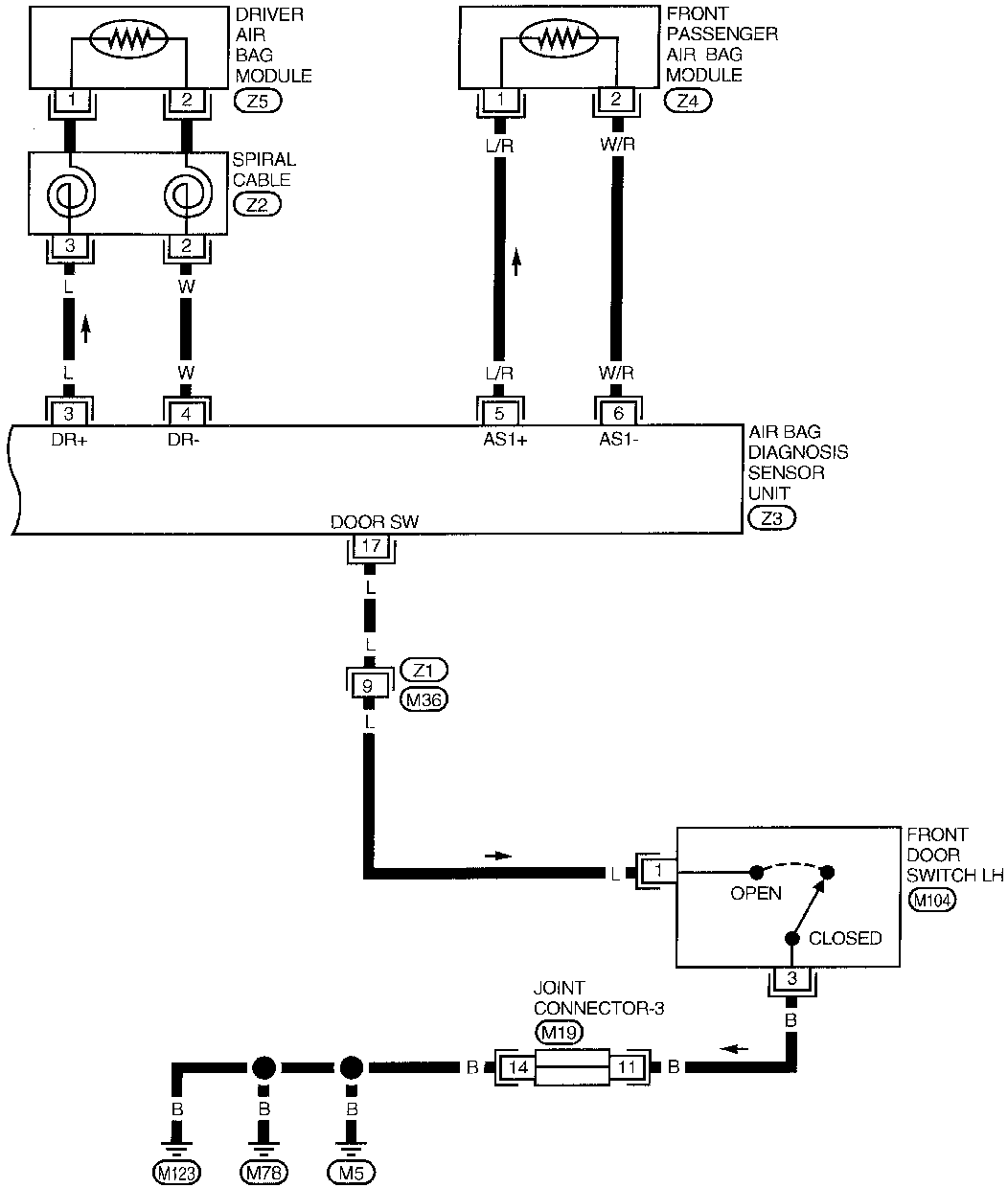

Refer to last page (Foldout page).

(M19)

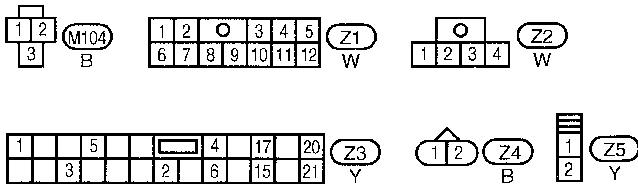

TROUBLE DIAGNOSES — Supplemental Restraint System (SRS)

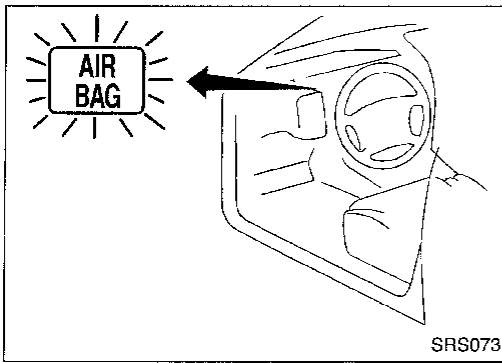

Self-diagnosis

DIAGNOSTIC PROCEDURE 1

Checking SRS operation by using "AIR BAG" warning lamp — User mode

1. After turning ignition switch from OFF to ON, "AIR BAG" warning lamp operates.
2. Compare "AIR BAG" warning lamp operation to the chart below.

GI
MA
EM
LC
EC
FE
AT
FA
BR
ST
RS
BT
HA
EL
IDX

"AIR BAG" warning lamp operation — User mode —	SRS condition	Reference item
<p>MRS095A</p>	No malfunction is detected. No further action is necessary.	—
<p>MRS096A</p>	The system has a problem and needs to be repaired as indicated.	Go to DIAGNOSTIC PROCEDURE 2, or 3, RS-32 or 34.
<p>MRS097A</p>	Air bag is deployed. Air bag fuse, diagnosis sensor unit or harness is malfunctioning and needs to be repaired.	Go to COLLISION DIAGNOSIS, RS-46. Go to DIAGNOSTIC PROCEDURE 8, RS-44.
<p>MRS098A</p>	One of the following has occurred and needs to be repaired. <ul style="list-style-type: none"> ● Meter fuse is blown. ● "AIR BAG" warning lamp circuit has open or short. ● Diagnosis sensor unit is malfunctioning. 	Go to DIAGNOSTIC PROCEDURE 9, RS-44.

NOTE:

If "AIR BAG" warning lamp operates differently from the operations shown above, refer to "AIR BAG" warning lamp operation — Diagnosis mode —, DIAGNOSTIC PROCEDURE 3 (step 4), RS-34. Then repair as necessary.

TROUBLE DIAGNOSES — Supplemental Restraint System (SRS)

Self-diagnosis (Cont'd)

DIAGNOSTIC PROCEDURE 2 (CONSULT) with CONSULT

Inspecting SRS malfunctioning parts by using CONSULT — Diagnosis mode

1. Turn ignition switch OFF.
2. Connect CONSULT to data link connector.

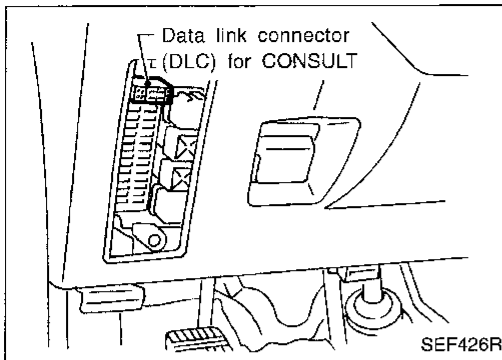

3. Turn ignition switch ON.
4. Touch "START".

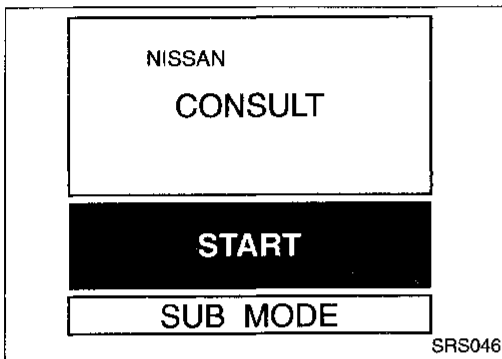

5. Touch "AIRBAG".

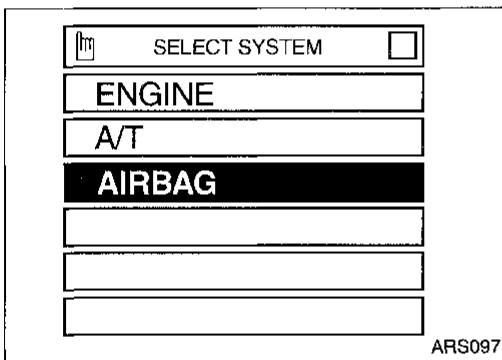

6. Touch "SELF-DIAG [CURRENT]".

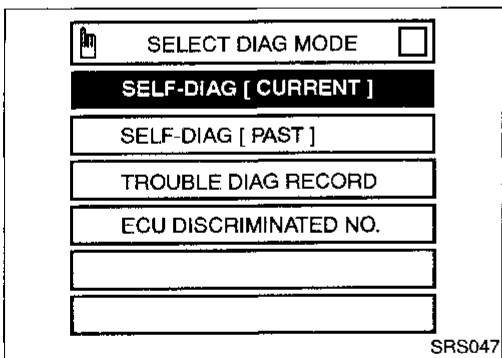

7. Diagnostic codes are displayed on "SELF-DIAG [CURRENT]".

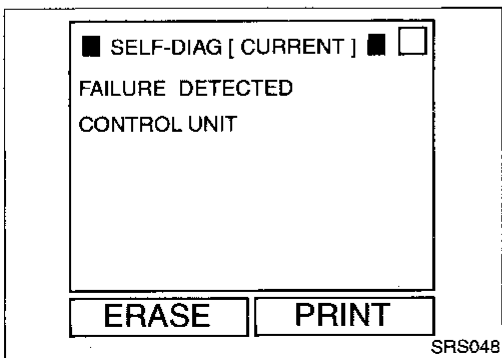

TROUBLE DIAGNOSES — Supplemental Restraint System (SRS)

Self-diagnosis (Cont'd)

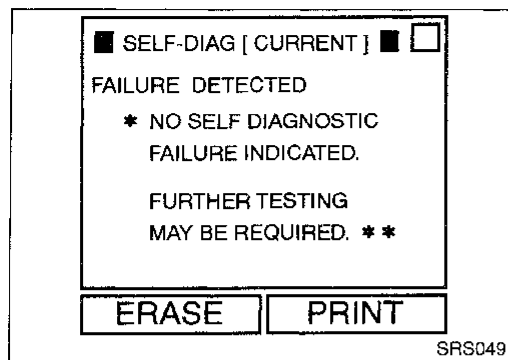

- If no self-diagnostic failure is detected on “SELF-DIAG [CURRENT]” even though a malfunction is detected in **DIAGNOSTIC PROCEDURE 1**, go to **DIAGNOSTIC PROCEDURE 6, RS-40**.
- 8. Touch “PRINT”.
- 9. Compare diagnostic codes to the **CONSULT DIAGNOSTIC CODE CHART**.
- 10. Touch “BACK” key of CONSULT until “SELECT SYSTEM” appears, then turn off CONSULT.
- 11. Turn ignition switch OFF, then disconnect CONSULT and both battery cables.
- 12. Repair the system as outlined by the Repair order in **CONSULT DIAGNOSTIC CODE CHART**, that corresponds to the problem code. For replacement procedure of component parts, refer to RS-16.
- 13. After repairing the system, connect battery cables and go to **DIAGNOSTIC PROCEDURE 4, RS-35**.

CONSULT DIAGNOSTIC CODE CHART (“SELF-DIAG [CURRENT]”)

Diagnostic item	Explanation/Possible causes	Repair order *Recheck SRS using CONSULT at each replacement
NO SELF DIAGNOSTIC FAILURE INDICATED	● No malfunction is detected.	Go to DIAGNOSTIC PROCEDURE 6, RS-40 .
AIRBAG MODULE [OPEN]	● Driver air bag module circuit is open (including the spiral cable).	1. Visually check the wiring harness connections.
AIRBAG MODULE [VB-SHORT]	● Driver air bag module circuit is shorted to some power supply circuit (including the spiral cable).	2. Replace the harness if it has visible damage.
AIRBAG MODULE [GND-SHORT]	● Driver air bag module circuit is shorted to ground (including the spiral cable).	3. Replace spiral cable.
AIRBAG MODULE [SHORT]	● Driver air bag module circuits are shorted to each other.	4. Replace driver's air bag module. (Before disposing of it, it must be deployed.)
ASSIST A/B MODULE [OPEN]	● The circuit for front passenger air bag module is open.	5. Replace diagnosis sensor unit.
ASSIST A/B MODULE [VB-SHORT]	● Front passenger air bag module circuit is shorted to some power supply circuit.	1. Visually check wiring harness connections.
ASSIST A/B MODULE 1 [GND-SHORT]	● Front passenger air bag module circuit is shorted to ground.	2. Replace the harness if it has visible damage.
ASSIST A/B MODULE 1 [SHORT]	● Front passenger air bag module circuits are shorted to each other.	3. Replace front passenger air bag module. (Before disposing of it, it must be deployed.)
CONTROL UNIT	● Diagnosis sensor unit is malfunctioning.	4. Replace diagnosis sensor unit.
INDEFINITE FAILURES [AIR BAG]	● Low battery voltage. (Less than 9V)	1. Visually check wiring harness connections. 2. Replace diagnosis sensor unit. 3. Replace the harness if it has visible damage.
		Go to DIAGNOSTIC PROCEDURE 4, RS-35 , after charging battery.

*Follow the procedures in numerical order when repairing malfunctioning parts. Confirm whether malfunction is eliminated using the “AIR BAG” warning lamp (in User mode) or CONSULT each time repair is finished. If malfunction is still observed, proceed to the next step. When malfunction is eliminated, further repair work is not required.

TROUBLE DIAGNOSES — Supplemental Restraint System (SRS)

Self-diagnosis (Cont'd)

DIAGNOSTIC PROCEDURE 3 (without CONSULT)

Inspecting SRS malfunctioning parts by using "AIR BAG" warning lamp — Diagnosis mode

NOTE:

SRS will not enter Diagnosis mode if no malfunction is detected in User mode.

1. Open driver's door.
2. Turn ignition switch from OFF to ON.
3. Press driver's door switch at least 5 times within 7 seconds after turning ignition switch ON.
SRS is now in Diagnosis mode.
4. "AIR BAG" warning lamp operates in Diagnosis mode as follows:

NOTE:

If SRS does not enter Diagnosis mode even though malfunction is detected in User mode, go to DIAGNOSTIC PROCEDURE 10, RS-45.

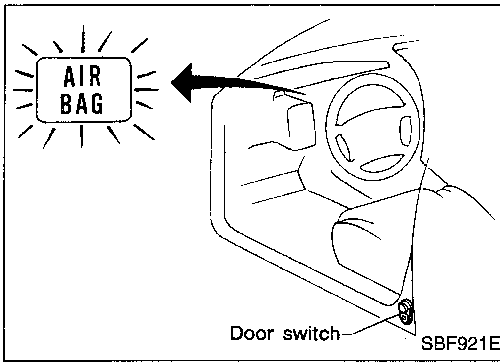

No.	"AIR BAG" warning lamp operation — Diagnosis mode —	SRS condition
1	<p style="text-align: right;">(a) through (b) are repeated.</p> <p style="text-align: center;">MRS100A</p>	Intermittent problem has been detected in the past. Go to DIAGNOSTIC PROCEDURE 7, RS-41.
2	<p style="text-align: right;">(a) through (d) are repeated. NOTE: (a) — Interval I (b) — Start signal (Start signal identifies display modes) (c) — Interval II (d) — Indicates malfunctioning part (0.5 sec. ON and 0.5 sec. OFF is counted as one flash)</p> <p style="text-align: center;">MRS099A</p>	The system has a problem and needs to be repaired.

5. Malfunctioning part is indicated by the number of flashes (part (d)). Compare the number of flashes to WARNING LAMP FLASH CODE CHART, RS-35, and locate malfunctioning part.
6. Turn ignition switch OFF, and disconnect both battery cables.
7. Repair the system as outlined by the Repair order in WARNING LAMP FLASH CODE CHART that corresponds to the flash code. For replacement procedure of component parts, refer to RS-16.
8. After repairing the system, go to DIAGNOSTIC PROCEDURE 5, RS-38.

TROUBLE DIAGNOSES — Supplemental Restraint System (SRS)

Self-diagnosis (Cont'd)

WARNING LAMP FLASH CODE CHART

Warning lamp	Flash code (d) (# of flashes)	Explanation	Repair order *Recheck SRS at each replacement
"AIR BAG" warning lamp	0	● No malfunction is detected.	1. Go to DIAGNOSTIC PROCEDURE 7, RS-41.
	2	● The driver air bag module circuit is malfunctioning.	1. Visually check the wiring harness connections. 2. Replace the spiral cable. 3. Replace the driver air bag module. (Before disposing of it, it must be deployed.) 4. Replace the diagnosis sensor unit. 5. Replace the air bag harness.
	7	● The diagnosis sensor unit is malfunctioning.	1. Visually check the wiring harness connections. 2. Replace the diagnosis sensor unit. 3. Replace the air bag harness. 4. Replace the main harness.
	8	● The front passenger air bag module circuit is malfunctioning.	1. Visually check the wiring harness connections. 2. Replace the front passenger air bag module. (Before disposing of it, it must be deployed.) 3. Replace the diagnosis sensor unit. 4. Replace the air bag harness.
	9	● Low battery voltage. ("Flash Code 9" may not show up even if the battery voltage is low.)	Go to DIAGNOSTIC PROCEDURE 5, RS-38, after charging battery.

*Follow the procedures in numerical order when repairing malfunctioning parts. Confirm whether malfunction is eliminated using the "AIR BAG" warning lamp (in User mode) or CONSULT each time repair is finished. If malfunction is still observed, proceed to the next step. When malfunction is eliminated, further repair work is not required.

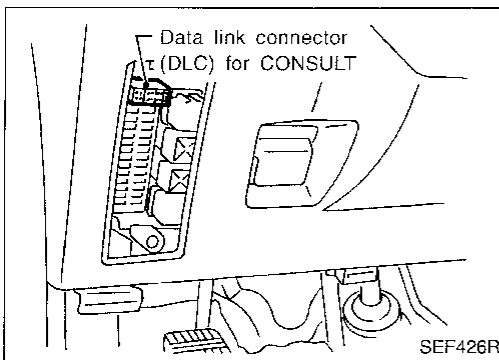

DIAGNOSTIC PROCEDURE 4 (CONSULT with CONSULT)

Final checking after repairing SRS by using CONSULT — Diagnosis mode

1. After repairing SRS, connect both battery cables.
2. Connect CONSULT to data link connector.
3. Turn ignition switch from OFF to ON.

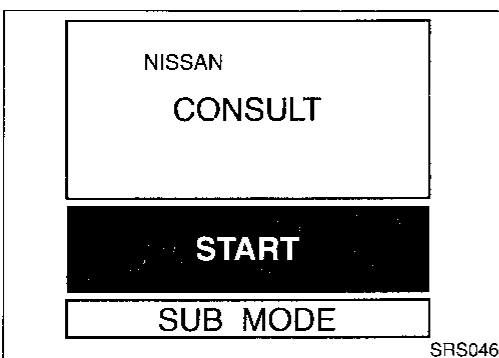

4. Touch "START".

Self-diagnosis (Cont'd)

SELECT SYSTEM

ENGINE

A/T

AIRBAG

ARS097

5. Touch "AIRBAG".

SELECT DIAG MODE

SELF-DIAG [CURRENT]

SELF-DIAG [PAST]

TROUBLE DIAG RECORD

ECU DISCRIMINATED NO.

SRS047

6. Touch "SELF-DIAG [CURRENT]".

■ SELF-DIAG [CURRENT] ■

FAILURE DETECTED

- * NO SELF DIAGNOSTIC FAILURE INDICATED.
- FURTHER TESTING MAY BE REQUIRED. **

ERASE PRINT

SRS049

7. If no malfunction is detected on "SELF-DIAG [CURRENT]", repair of SRS is completed. Touch "ERASE".

NOTE:

Touch "ERASE" to clear problem (Trouble code) retained in memory. Otherwise, the diagnosis sensor unit will still sense problem in memory when step 13 (Air bag warning lamp operation check) is performed. As a result, the "AIR BAG" warning lamp will still indicate a malfunction in the system.

■ SELF-DIAG [CURRENT] ■

FAILURE DETECTED

CONTROL UNIT

ERASE PRINT

SRS048

- If any problem code was displayed on "SELF-DIAG [CURRENT]", the malfunctioning part is not repaired completely or another malfunctioning part is detected. Go to DIAGNOSTIC PROCEDURE 2, RS-32, and repair malfunctioning part completely.

8. Touch "BACK" key of CONSULT.

SELECT DIAG MODE

SELF-DIAG [CURRENT]

SELF-DIAG [PAST]

TROUBLE DIAG RECORD

ECU DISCRIMINATED NO.

SRS050

9. Touch "SELF-DIAG [PAST]".

TROUBLE DIAGNOSES — Supplemental Restraint System (SRS)

Self-diagnosis (Cont'd)

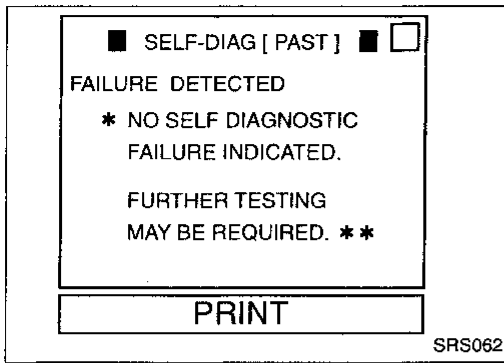

10. Check that no self-diagnostic failure is detected on "SELF-DIAG [PAST]".

11. Touch "BACK" key of CONSULT until "SELECT SYSTEM" appears, turn off CONSULT, then disconnect CONSULT.
12. Turn ignition switch OFF.
13. Go to DIAGNOSTIC PROCEDURE 1, RS-31 to check SRS operation by using "AIR BAG" warning lamp in User mode.

GI

MA

EM

LC

EC

FE

AT

FA

RA

BR

ST

RS

BT

HA

EL

IDX

TROUBLE DIAGNOSES — Supplemental Restraint System (SRS)

Self-diagnosis (Cont'd)

DIAGNOSTIC PROCEDURE 5 (without CONSULT)

Final checking after repairing SRS by using "AIR BAG" warning lamp — Diagnosis mode and User mode

1. After repairing SRS, connect both battery cables.
2. Open driver's door.
3. Turn ignition switch from OFF to ON.
4. "AIR BAG" warning lamp operates in Diagnosis mode as follows:

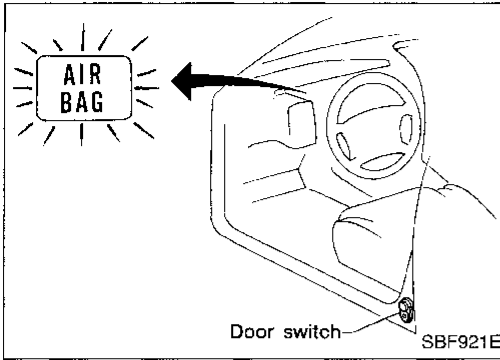

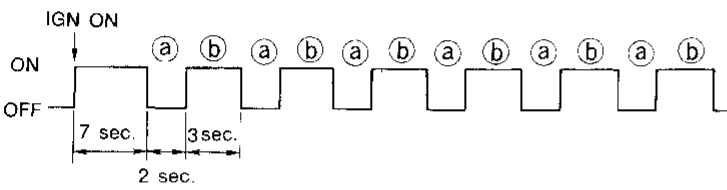
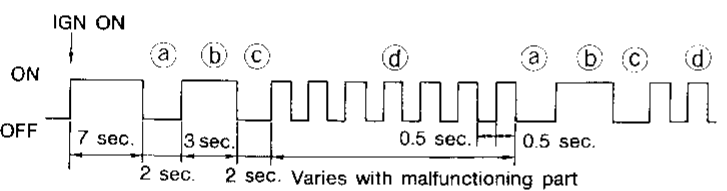
No.	"AIR BAG" warning lamp operation — Diagnosis mode —	SRS condition
1	 <p style="text-align: right;">MRS100A</p>	<p>(a) through (b) are repeated.</p> <p>No malfunction is detected or repair is completed. No further action is necessary.</p>
2	 <p style="text-align: right;">MRS099A</p>	<p>(a) through (d) are repeated.</p> <p>NOTE:</p> <p>(a) — Interval I</p> <p>(b) — Start signal (Start signal identifies display modes)</p> <p>(c) — Interval II</p> <p>(d) — Indicates malfunctioning part (0.5 sec. ON and 0.5 sec. OFF is counted as one flash)</p> <p>The system has a problem and needs to be repaired.</p>

NOTE:

When diagnosis sensor unit is replaced with a new one; the "AIR BAG" warning lamp will operate in User mode. Checking the "AIR BAG" warning lamp operation in Diagnosis mode is not required. Go to step 6.

5. If "AIR BAG" warning lamp operates as shown in No. 1 in the chart above, turn ignition switch OFF to reset from Diagnosis mode to User mode. Then go to step 6.

If "AIR BAG" warning lamp operates as in No. 2 in chart above, the malfunctioning part is not repaired completely, or another malfunctioning part is detected. Go to DIAGNOSTIC PROCEDURE 3, RS-34, and repair malfunctioning part completely.

TROUBLE DIAGNOSES — Supplemental Restraint System (SRS)



Self-diagnosis (Cont'd)

6. Turn ignition switch ON. "AIR BAG" warning lamp operates in User mode. Compare "AIR BAG" warning lamp operation to the chart below.

NOTE:

If switching Diagnosis mode to User mode is required while malfunction is being detected, turn ignition switch from OFF to ON. Then press driver's door switch at least 5 times within 7 seconds after turning ignition switch ON.

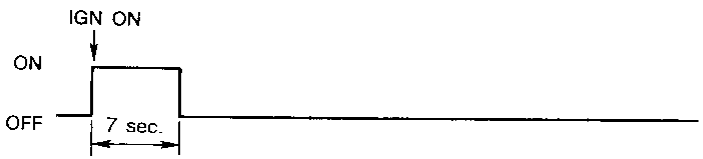
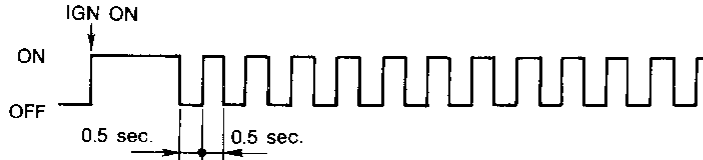
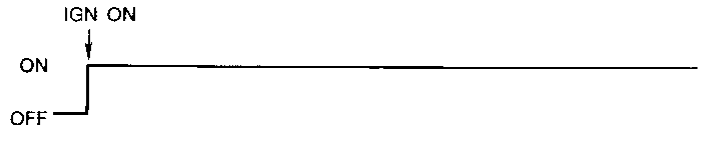
SRS is now in User mode.

"AIR BAG" warning lamp operation — User mode —	SRS condition	Reference item
 <p>MRS095A</p>	<p>No malfunction is detected. No further action is necessary.</p>	<p>—</p>
 <p>MRS096A</p>	<p>The system has a problem and needs to be repaired as indicated.</p>	<p>Go to DIAGNOSTIC PROCEDURE 2 or 3, RS-32 or 34.</p>
 <p>MRS097A</p>	<p>Air bag is deployed.</p> <p>Air bag fuse, diagnosis sensor unit or harness is malfunctioning and needs to be repaired.</p>	<p>Go to COLLISION DIAGNOSIS, RS-46.</p> <p>Go to DIAGNOSTIC PROCEDURE 8, RS-44.</p>
 <p>MRS098A</p>	<p>One of the following has occurred and needs to be repaired.</p> <ul style="list-style-type: none"> ● Meter fuse is blown. ● "AIR BAG" warning lamp circuit has open or short. ● Diagnosis sensor unit is malfunctioning. 	<p>Go to DIAGNOSTIC PROCEDURE 9, RS-44.</p>

GI

MA

EM

LC

EC

FE

AT

FA

RA

BR

ST

RS

BT

HA

EL

IDX

TROUBLE DIAGNOSES — Supplemental Restraint System (SRS)

Self-diagnosis (Cont'd)

DIAGNOSTIC PROCEDURE 6 (Continued from DIAGNOSTIC PROCEDURE 2)

Inspecting SRS malfunctioning record

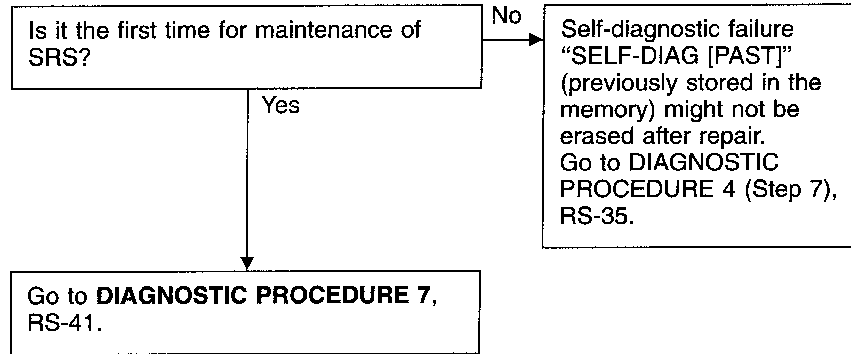

TROUBLE DIAGNOSES — Supplemental Restraint System (SRS)

Self-diagnosis (Cont'd)

DIAGNOSTIC PROCEDURE 7 (CONSULT) with CONSULT

Inspecting SRS intermittent problem by using CONSULT — Diagnosis mode

1. Turn ignition switch OFF.
2. Connect CONSULT to data link connector.

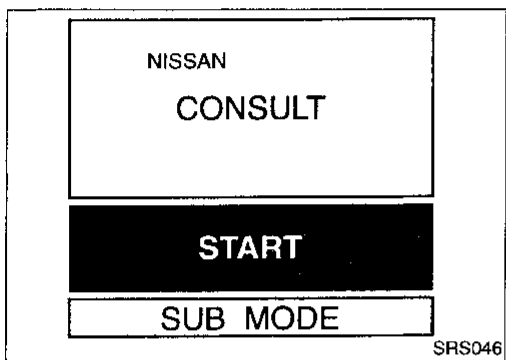
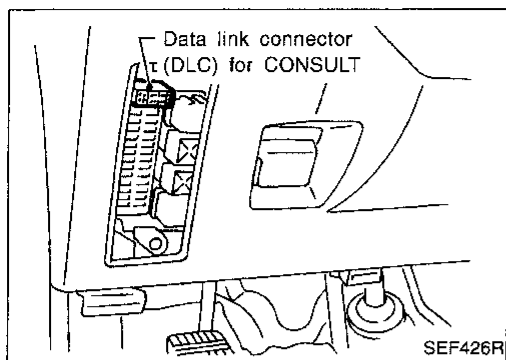

3. Turn ignition switch ON.
4. Touch "START".

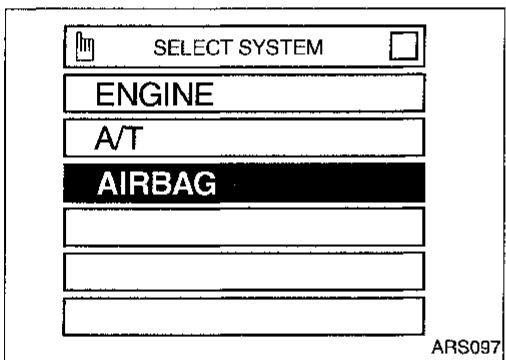

5. Touch "AIRBAG".

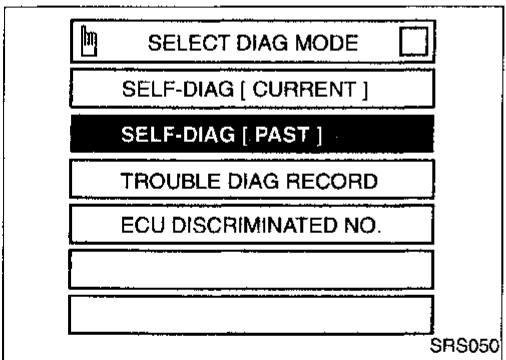

6. Touch "SELF-DIAG [PAST]".

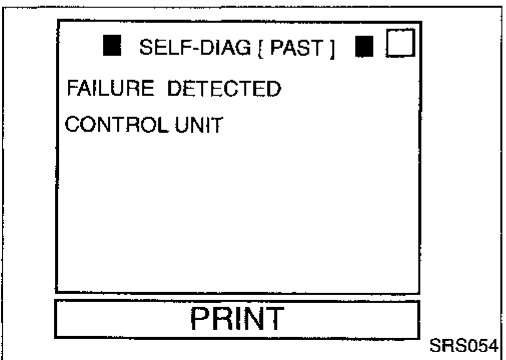

7. If diagnostic codes are displayed on "SELF-DIAG [PAST]", go to step 10.

GI

MA

EM

LC

EC

FE

AT

FA

RA

BR

ST

RS

BT

HA

EL

IDX

TROUBLE DIAGNOSES — Supplemental Restraint System (SRS)

Self-diagnosis (Cont'd)

If no self-diagnostic failure is detected on "SELF-DIAG [PAST]", touch "BACK" and go back to "SELECT DIAG MODE".

■ SELF-DIAG [PAST] ■

FAILURE DETECTED

* NO SELF DIAGNOSTIC FAILURE INDICATED.

FURTHER TESTING MAY BE REQUIRED. **

PRINT

SRS062

SELECT DIAG MODE

SELF-DIAG [CURRENT]

SELF-DIAG [PAST]

TROUBLE DIAG RECORD

ECU DISCRIMINATED NO.

SRS055

8. Touch "TROUBLE DIAG RECORD".

■ TROUBLE DIAG RECORD ■

FAILURE DETECTED

ASSIST A/B MODULE [OPEN]

PRINT

SRS056

9. Diagnostic code is displayed on "TROUBLE DIAG RECORD".

10. Touch "PRINT".
11. Compare diagnostic codes to the INTERMITTENT PROBLEM DIAGNOSTIC CODE CHART, RS-43.
12. Touch "BACK" key of CONSULT until SELECT SYSTEM appears, then turn off CONSULT.
13. Turn ignition switch OFF, then disconnect CONSULT and both battery cables.
14. Repair the system as outlined by the Repair order in INTERMITTENT PROBLEM DIAGNOSTIC CODE CHART, that corresponds to the problem code, refer to RS-43. For replacement procedure of component parts, refer to RS-16.
15. Go to DIAGNOSTIC PROCEDURE 4, RS-35 for final checking.

TROUBLE DIAGNOSES — Supplemental Restraint System (SRS)

Self-diagnosis (Cont'd)

INTERMITTENT PROBLEM DIAGNOSTIC CODE CHART (“SELF-DIAG [PAST]” or “TROUBLE DIAG RECORD”)

Diagnostic item	Explanation	Repair order *Recheck SRS at each replacement.
NO SELF-DIAGNOSTIC FAILURE INDICATED.	<ul style="list-style-type: none"> No malfunction is detected. 	<ul style="list-style-type: none"> Go to DIAGNOSTIC PROCEDURE 4, RS-35, after charging battery.
AIRBAG MODULE [OPEN]	<ul style="list-style-type: none"> Driver's air bag module circuit is open. (including the spiral cable) 	<ul style="list-style-type: none"> Replace driver's air bag module. (Before disposal of it, it must be deployed.) Replace the spiral cable. Replace the diagnosis sensor unit. Replace the harness if it has visible damage.
AIRBAG MODULE [VB-SHORT]	<ul style="list-style-type: none"> Driver's air bag module circuit is shorted to some power supply circuit. (including the spiral cable) 	
AIRBAG MODULE [GND-SHORT]	<ul style="list-style-type: none"> Driver's air bag module circuit is shorted to ground. (including the spiral cable) 	
AIRBAG MODULE [SHORT]	<ul style="list-style-type: none"> Driver's air bag module circuits are shorted to each other. 	
ASSIST A/B MODULE [VB-SHORT]	<ul style="list-style-type: none"> Front passenger air bag module circuit is shorted to some power supply circuit. 	<ul style="list-style-type: none"> Replace front passenger air bag module. (Before disposal of it, it must be deployed.) Replace the diagnosis sensor unit. Replace the harness if it has visible damage.
ASSIST A/B MODULE [OPEN]	<ul style="list-style-type: none"> Front passenger air bag module circuit is open. 	
ASSIST A/B MODULE [GND-SHORT]	<ul style="list-style-type: none"> Front passenger air bag module circuit is shorted to ground. 	
ASSIST A/B MODULE [SHORT]	<ul style="list-style-type: none"> Front passenger air bag module circuits are shorted to each other. 	
CONTROL UNIT	<ul style="list-style-type: none"> Diagnosis sensor unit is out of order. 	<ul style="list-style-type: none"> Replace the diagnosis sensor unit.
INDEFINITE FAILURES [AIR BAG]	<ul style="list-style-type: none"> Low battery voltage. 	<ul style="list-style-type: none"> Go to DIAGNOSIS PROCEDURE 4, RS-35, after charging battery.

*Intermittent problem areas cannot be easily located. For this reason, perform the procedures outlined under the repair order, then make the final system check.

GI

MA

EM

LC

EC

FE

AT

FA

RA

BR

ST

RS

BT

HA

EL

IDX

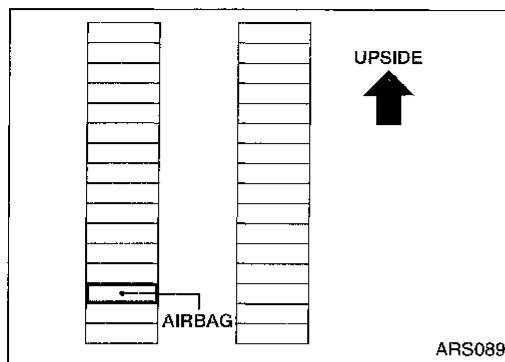

ARS089

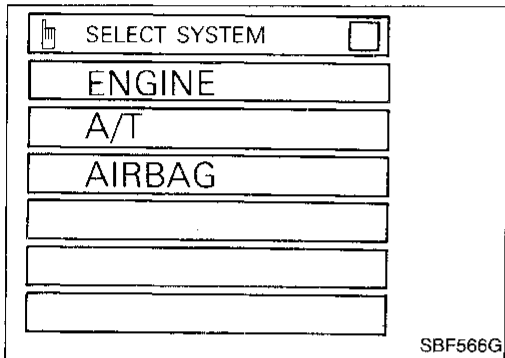

SBF566G

Trouble Diagnoses for Air Bag Warning Lamp DIAGNOSTIC PROCEDURE 8

SYMPTOM: "AIR BAG" warning lamp does not turn off.

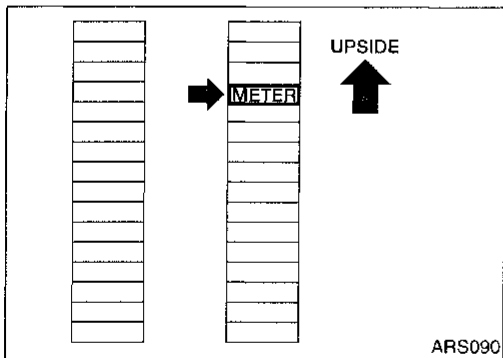
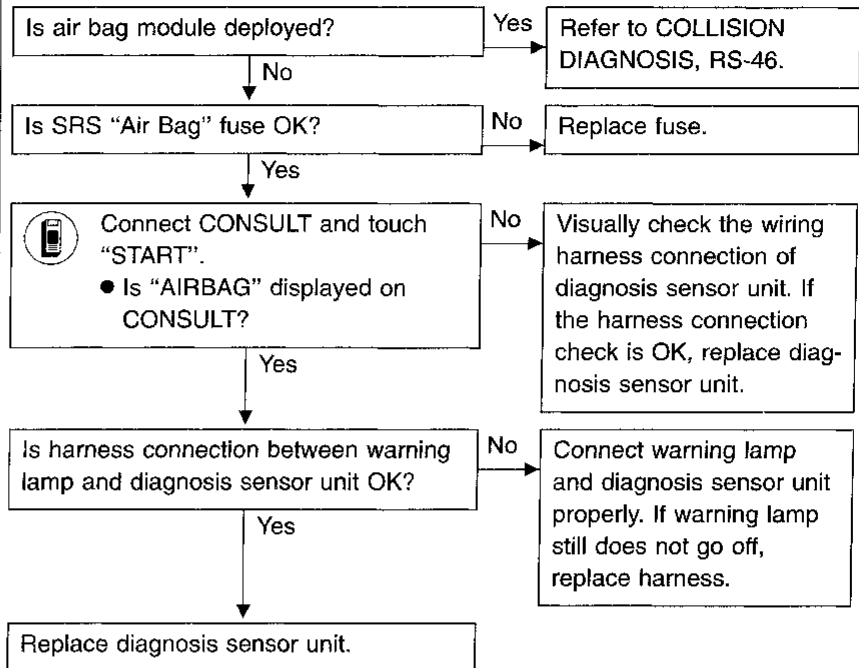

ARS090

DIAGNOSTIC PROCEDURE 9

SYMPTOM: "AIR BAG" warning lamp does not turn on.

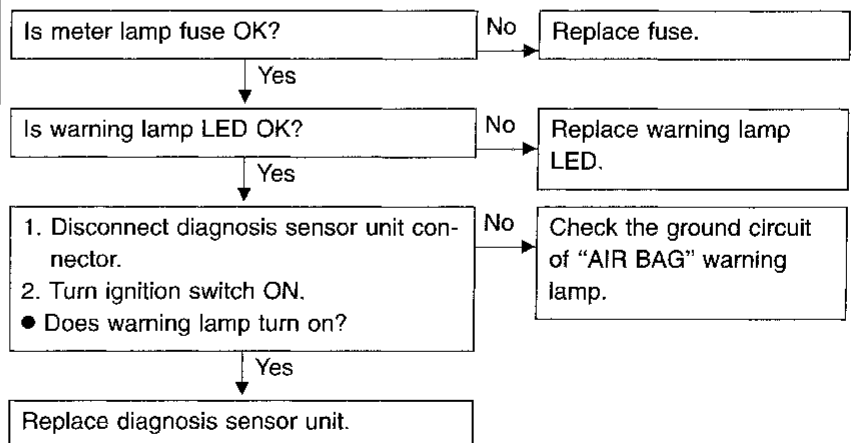

TROUBLE DIAGNOSES — Supplemental Restraint System (SRS)

Trouble Diagnoses for Air Bag Warning Lamp (Cont'd)

DIAGNOSTIC PROCEDURE 10

SYMPTOM: SRS does not enter Diagnosis mode using door switch.

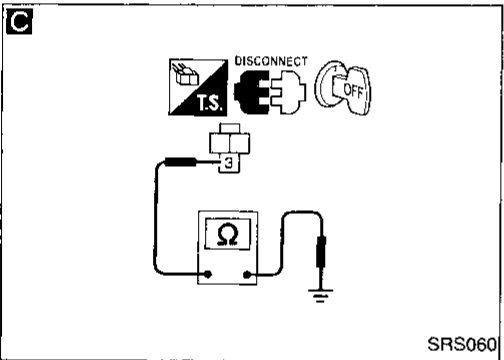
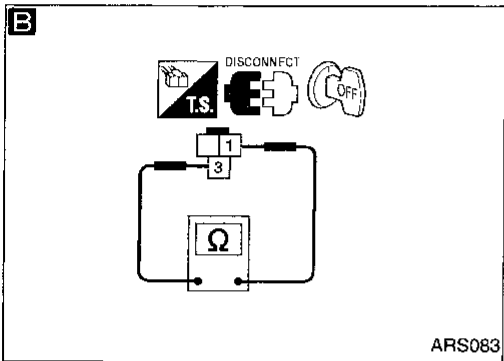
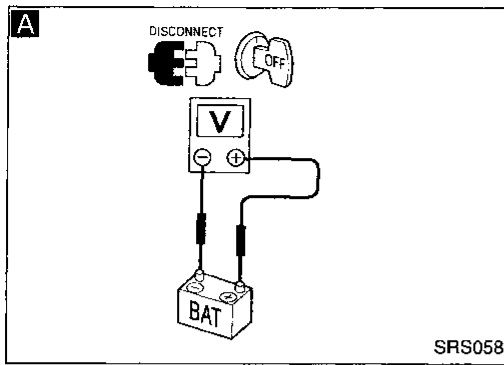

A Disconnect both battery cables and check battery voltage using circuit tester.
 ● Is battery voltage more than 9V?

No → Charge battery.

Yes

B Remove driver's door switch and check continuity between driver's door switch connector terminals ① and ③ under the following conditions.

No → Replace driver's door switch.

Condition	Continuity
Door switch is depressed (Door is closed).	NO
Door switch is released (Door is open).	YES

Yes

C Check harness continuity between driver's door switch connector terminal ③ and body ground.
 ● Does continuity exist?

No → Replace or repair harness.

Yes
 Replace diagnosis sensor unit.

Go to **DIAGNOSTIC PROCEDURE 1, RS-31.**

GI
 MA
 EM
 LC
 EC
 FE
 AT
 FA
 RA
 BR
 ST
RS
 BT
 HA
 EL
 IDX

COLLISION DIAGNOSIS

To repair the SRS, perform the following steps.

When SRS is activated in a collision:

- ① Replace the diagnosis sensor unit.
- ② Remove the air bag modules.
- ③ Check the SRS components using the table shown below:
 - Replace any SRS components showing visible signs of damage (dents, cracks, deformation).
- ④ Install new air bag modules.
- ⑤ Conduct self-diagnosis using CONSULT and “AIR BAG” warning lamp. Refer to “Self diagnosis”, RS-31, for details. Ensure that the entire SRS operates properly.

When SRS is not activated in a collision:

- ① Check the SRS components using the table shown below:
 - Replace any SRS components showing visible signs of damage (dents, cracks, deformation).
- ② Conduct self-diagnosis using CONSULT and “AIR BAG” warning lamp. Refer to “Self-diagnosis”, RS-31, for details. Ensure that the entire SRS operates properly.

COLLISION DIAGNOSIS

SRS inspection

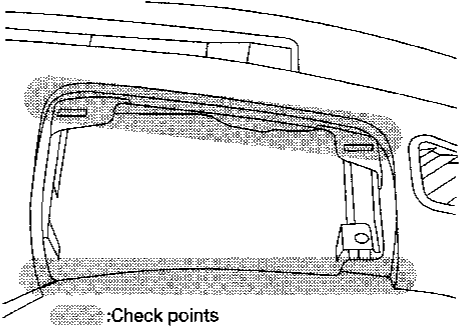
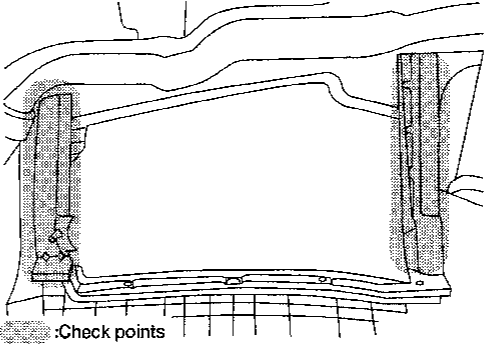
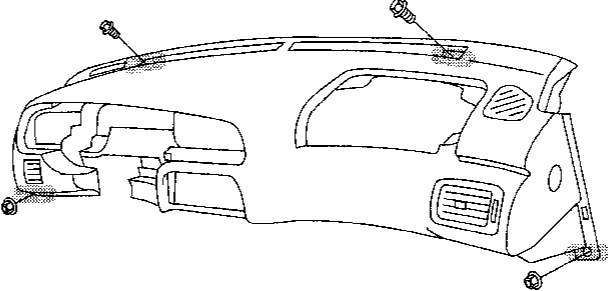
Part	SRS is activated	SRS is NOT activated
Air bag module (driver and passenger side)	REPLACE Install with new bolts.	<ol style="list-style-type: none"> 1. Remove air bag module. Check harness cover and connectors for damage, terminals for deformities, and harness for binding. 2-1. Install driver air bag module into the steering wheel to check fit and alignment. 2-2. Install front passenger air bag module into the instrument panel to check fit and alignment. 3. No damage found, reinstall with new bolts. 4. If damaged—REPLACE. Air bag must be deployed before discarding.
Diagnosis sensor unit	REPLACE Install with new bolts.	<ol style="list-style-type: none"> 1. Check case and bracket for dents, cracks and deformities. 2. Check connectors for damage, and terminals for deformities. 3. If no damage is found, reinstall with new bolts. 4. If damaged—REPLACE.
Instrument panel	<ol style="list-style-type: none"> 1. When passenger air bag inflates, check the following points for bending, deformities and cracks: <ul style="list-style-type: none"> ● Opening portion for passenger air bag ex. (Details differ among models.) <div style="text-align: center; margin: 10px 0;">  <p style="text-align: center;">:Check points</p> </div> <ul style="list-style-type: none"> ● Passenger air bag module brackets ex. (Details differ among models.) <div style="text-align: center; margin: 10px 0;">  <p style="text-align: center;">:Check points</p> </div> <ul style="list-style-type: none"> ● The portions securing the instrument panel ex. (Details differ among models.) <div style="text-align: center; margin: 10px 0;">  <p style="text-align: center;">:Check points</p> </div> <ol style="list-style-type: none"> 2. If no damage is found, reinstall the instrument panel. 3. If damaged - REPLACE the instrument panel with new bolts. 	

GI
 MA
 EM
 LC
 EC
 FE
 AT
 FA
 RA
 BR
 ST
RS
 BT
 HA
 EL
 IDX

COLLISION DIAGNOSIS

Part	
Steering wheel	<ol style="list-style-type: none">1. Visually check steering wheel for deformities.2. Check harness (built into steering wheel) and connectors for damage, and terminals for deformities.3. Install driver air bag module to check fit and alignment.4. Check steering wheel for excessive free play.5. If no damage is found, reinstall the steering wheel.6. If damaged—REPLACE.
Spiral cable	<ol style="list-style-type: none">1. Visually check spiral cable and combination switch for damage.2. Check connectors, flat cable and protective tape for damage.3. Check steering wheel for noise, binding and heavy operation.4. If no damage is found, reinstall the spiral cable.5. If damaged—REPLACE.
Harness and Connectors	<ol style="list-style-type: none">1. Check connectors for poor connection, damage, and terminals for deformities.2. Check harness for binding, chafing, cuts, and deformities.3. If no damage is found, reinstall.4. Damaged—REPLACE damaged section of harness. Do not attempt to repair, splice or modify any SRS harness.