

A

ACC

SECTION ACC

ACCELERATOR CONTROL SYSTEM

C

CONTENTS

D

E

ACCELERATOR CONTROL SYSTEM 2	SERVICE DATA AND SPECIFICATIONS (SDS) 4	F
Components 2	Accelerator Control 4	
Removal and Installation 2	ACCELERATOR PEDAL 4	G
REMOVAL 2		
INSTALLATION 2		H
INSPECTION AFTER INSTALLATION 3		

I

J

K

L

M

Components

EBS0003T

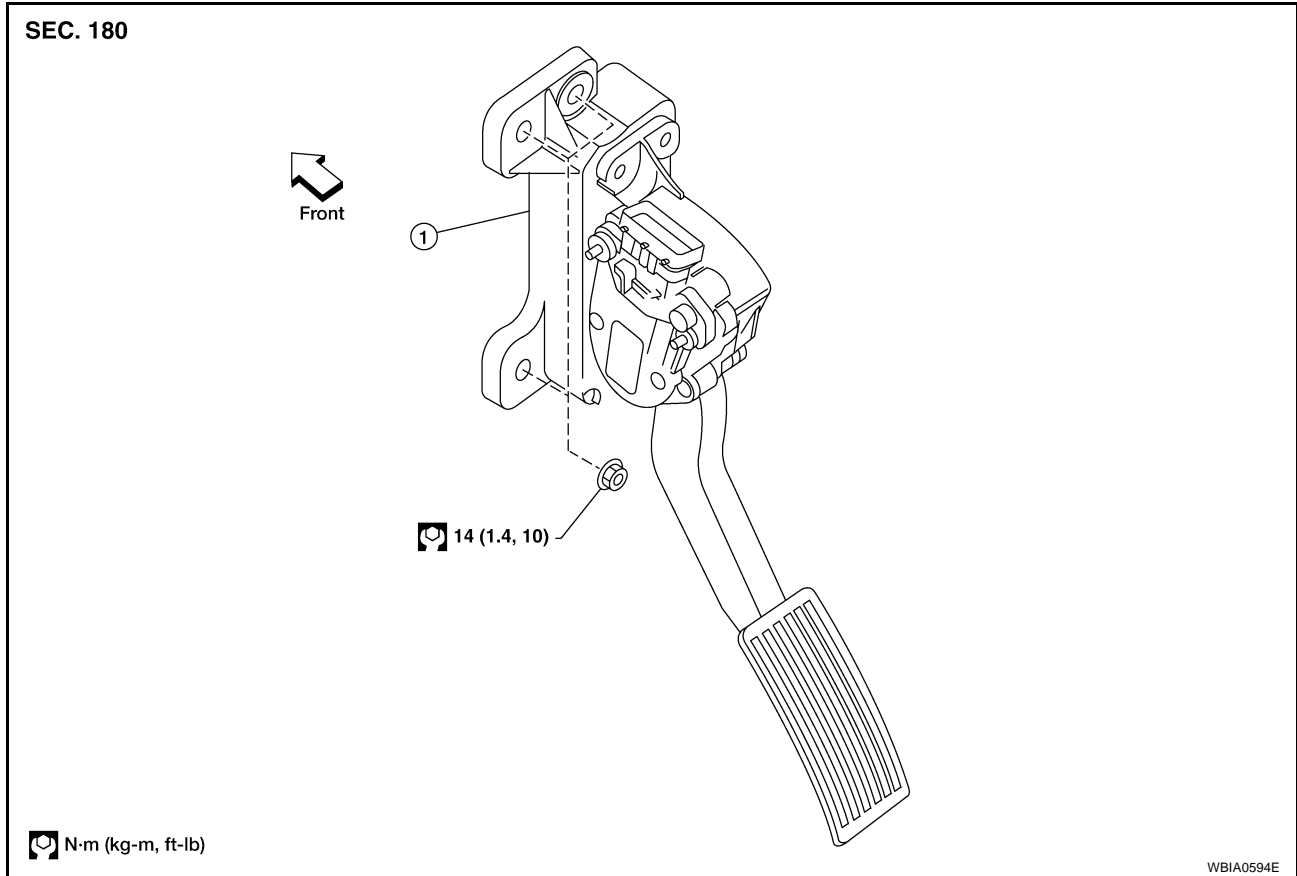

1. Non-adjustable accelerator pedal assembly

CAUTION:

- Do not disassemble the accelerator pedal assembly.
- Do not remove the accelerator pedal position sensor from the accelerator pedal bracket.
- Avoid damage from dropping the accelerator pedal assembly during handling.
- Keep the accelerator pedal assembly away from water.

Removal and Installation

EBS0003U

REMOVAL

1. Disconnect the negative battery terminal.
2. Disconnect the accelerator position sensor electrical connector.
 - a. Pull the connector lock back to unlock the connector from the accelerator pedal position sensor as shown.
 - b. Pull up on the connector to disconnect it from the accelerator pedal position sensor as shown.
3. Remove the two upper and one lower accelerator pedal nuts.
4. Remove the accelerator pedal assembly.

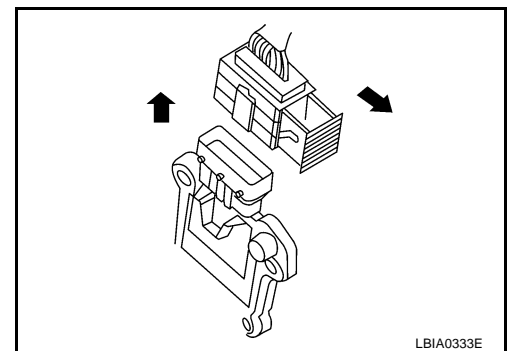

CAUTION:

- Do not disassemble the accelerator pedal assembly.
- Do not remove the accelerator pedal position sensor from the accelerator pedal bracket.
- Avoid damage from dropping the accelerator pedal assembly during handling.
- Keep the accelerator pedal assembly away from water.

INSTALLATION

Installation is in the reverse order of removal.

ACCELERATOR CONTROL SYSTEM

INSPECTION AFTER INSTALLATION

- Check that the accelerator pedal moves smoothly within the specified range.

Accelerator pedal - total pedal applied stroke "A" : 48 mm (1.89 in)

- Check that the accelerator pedal smoothly returns to the original position.
- Perform an electrical inspection of the accelerator pedal position sensor. Refer to [EC-659, "DTC P2138 APP SENSOR"](#).

CAUTION:

When the harness connector of the accelerator pedal position sensor is disconnected, perform "Accelerator Pedal Released Position Learning". Refer to [EC-89, "Accelerator Pedal Released Position Learning"](#).

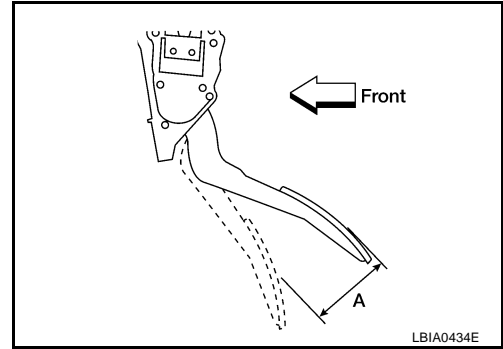

A

ACC

C

D

E

F

G

H

I

J

K

L

M

SERVICE DATA AND SPECIFICATIONS (SDS)

SERVICE DATA AND SPECIFICATIONS (SDS)

PFP:00030

Accelerator Control ACCELERATOR PEDAL

EBS0003V

Unit: mm (in)

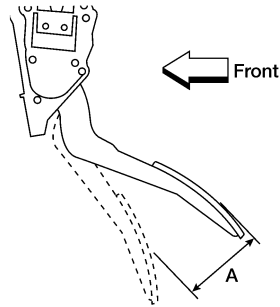

LBIA0434E

Accelerator pedal - total pedal applied stroke "A"	48 (1.89)
--	-----------